

# LED WORKPLACE LIGHTS



# LED2WORK

INTELLIGENCE IN LIGHT

- is a climate-neutral company
- founded in 2007
- develops and manufactures its products in Germany
- has a subsidiary in the USA: LED2WORK Inc. Chicago
- always uses the latest LED technology
- produces more than 100,000 LED lights a year

## Our LED workplace lights:

- are suitable for all work involving visual tasks, such as at manual workstations, system and assembly stations and at test stations
- are energy-efficient and produce bright, high-contrast light
- feature the latest high-performance LED technology
- guarantee top-quality workmanship and long service life
- are easy to install or retrofit

**Put simply: CONVINCING QUALITY!**







# Contents

## LED workplace lights

CENALED SPOT Flexarm	4
CENALED LENS Flexarm	6
CENALED FLOOD Flexarm	8
CENALED SPOT Articulated arm	10
LENsled II	12
UNILED II	14
UNILED II TUNABLE WHITE	16
SYSTEMLED EVO	18
SYSTEMLED EVO PIR	22
SYSTEMLED SurfaceOne	26
UNILED SL	28
UNILED SL RGB-W	30
PROFILED DC und PROFILED AC	32
PROFILED AC adjustable pull pendant	35
Accessories for LED lights	36



## LED workplace lights with flex arms



### LED workplace light for pinpoint illumination **CENALED SPOT Flexarm**

Our handy LED light CENALED SPOT Flexarm lights up any work environment. It can be used in manual workstations, at workbenches or can be used to focus light in the processing area of machines. The flexible flex arm is encased. The base and light head are made of die-cast aluminium. Light is emitted by high-performance LED chips that are protected by safety glass. The practical CENALED SPOT Flexarm light can be quickly brought into play wherever light is needed.

#### Technology

- High-power LED chips for neutral white
- On/off and dimmable using push-button on light head
- High-quality 500 mm gooseneck – flexible, tested for 20,000 bending cycles and fitted with an oil-resistant sheath
- Available as a 24V DC variant or for direct connection to 100–305V AC, each with a 3 m power cord

#### Your benefits

- Compact light for powerful, neutral white illumination with outstanding detail sharpness
- Flicker-free light with no UV or IR content
- Can be precisely positioned using the adjustable flex arm
- 30° beam angle for focused illumination

#### Areas of application

- Manual workstations for goldsmiths or watchmakers
- Workstations at machines without their own lighting (e.g. drills) if light is needed in certain spots or at short notice

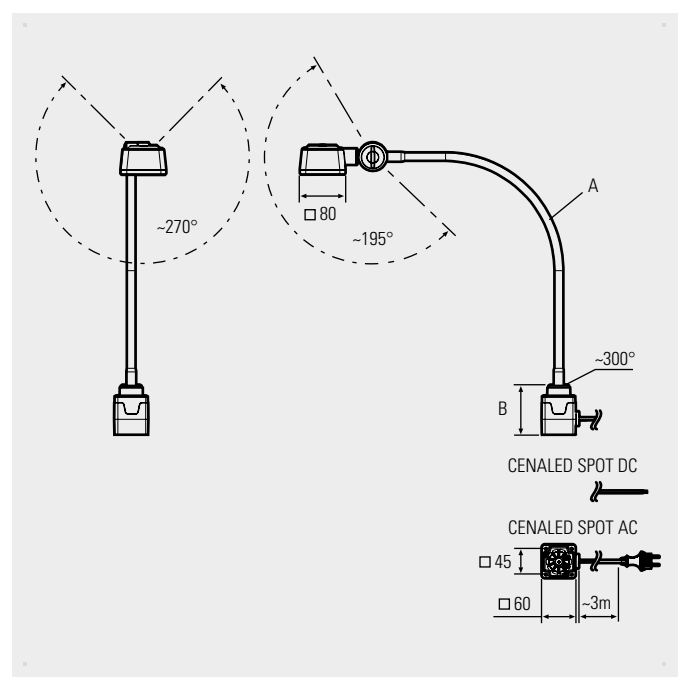



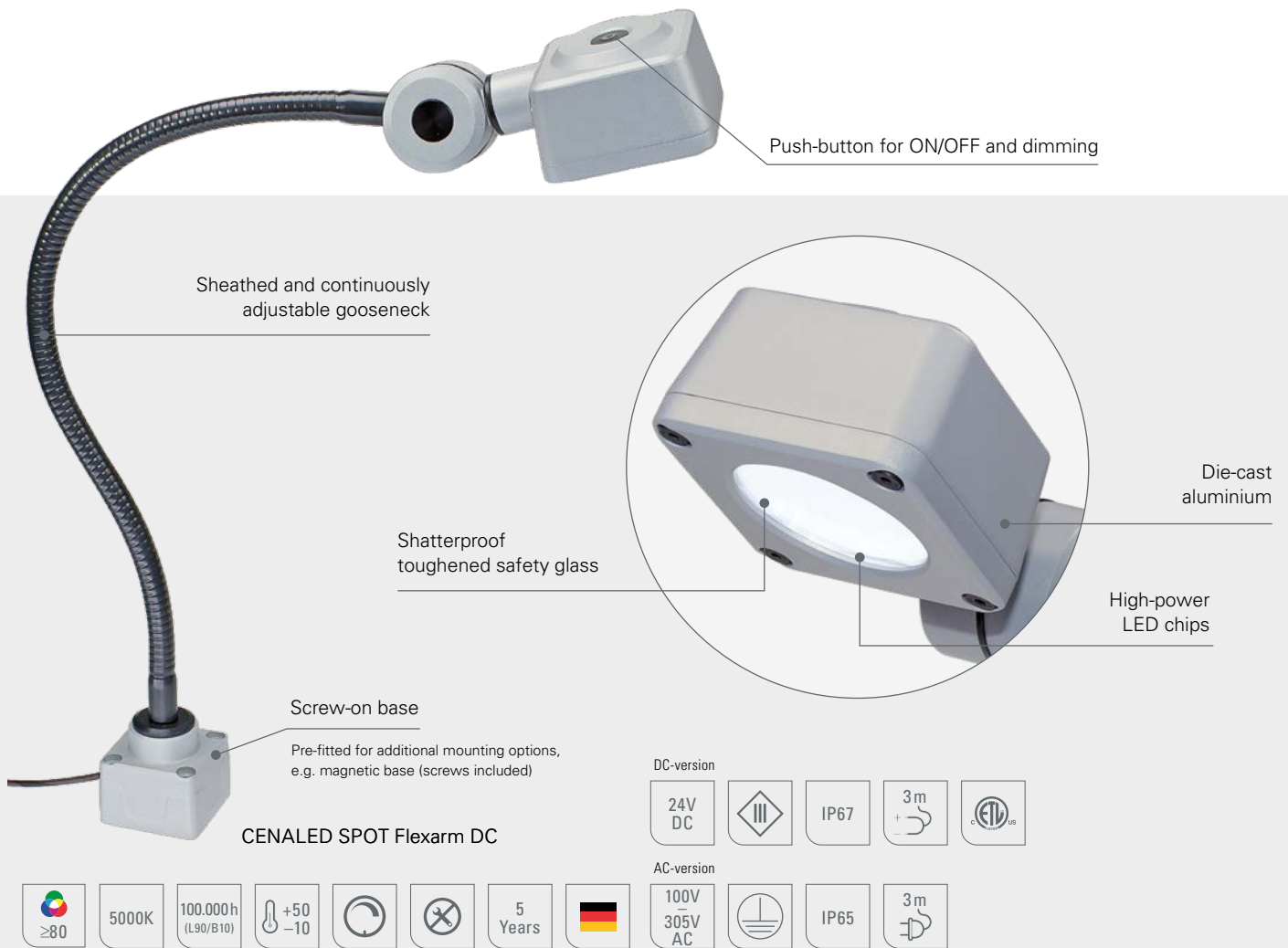

LED light	Item no.	Arm length (A)	Base (B)	Optics	E <sub>max</sub> *	Luminous flux	Power	Connection
CENALED SPOT Flex arm DC	121012-01	500 mm	59 mm	30°	8584 lx	1120 lm	-8.5 W	24V DC
CENALED SPOT Flex arm AC	121012-11	500 mm	88 mm	30°	8584 lx	1120 lm	-9 W	100-305V AC

For 24V DC power supply units, see the Accessories page in the appendix

\* Maximum level of illumination, measurement field 100 cm x 100 cm at distance of 50 cm

Accessories	Item no.
Magnetic clamp for CENALED screw-on base (holding force 600 N)	220500-01
Table clamp for CENALED screw-on base	220500-02
Wall bracket for CENALED screw-on base	220500-03



The CENALED SPOT Flexarm is part of the CENALED modular system. All housing parts are made of die-cast aluminium in solid industrial quality. The screw-on base for a 24V DC or 100-305V AC connection forms the basis of every light. The light is supplemented by an articulated arm, flex arm or directly mounted articulated head. The light head is the same in all versions and features an on/off switch and brightness control (dimming). The screw-on base can be combined with various mounting options, e.g. a magnetic clamp or table clamp.

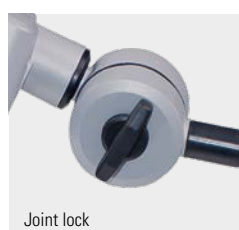



## LED magnifying workplace light CENALED LENS Flexarm

This magnifying light with double magnification features a flexible gooseneck that holds the light head securely in position once it has been adjusted. The CENALED LENS Flexarm can be used to view even the smallest components in great detail. The magnified area below the lens is perfectly illuminated. The high illumination level means that the LED light can be used as a simple workplace light. The magnifying light is supplied with a lens cover for this purpose. The cover is magnetic and can be easily attached to the gooseneck when not protecting the lens.

### Technology

- High-power LED ring for daylight white light
- 4 dpt glass lens, focal length 250 mm
- On/off and dimmable using push-button on light head
- High-quality 500 mm gooseneck – manoeuvrable, tested for 20,000 bending cycles and fitted with an oil-resistant sheath
- Available as a 24V DC variant or for direct connection to 100–305V AC, each with a 3 m power cord

### Your benefits

- Compact magnifying light for object magnification and illumination of the magnification area with outstanding detail sharpness
- Flicker-free light with no UV or IR content
- Light and magnifier can be moved and adjusted with precision
- Beam angle of 120° and opal white glare control

### Areas of application

- Manual and testing workstations
- Workstations at machines and installations

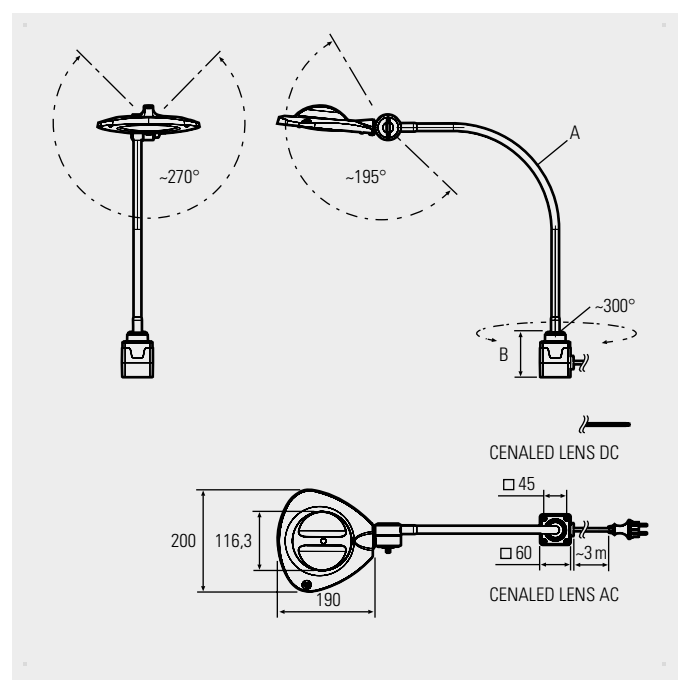



**CENALED LENS Flexarm DC**

IP54	≥85	5700K	100.000 h (L80/B10)	+50 -10		5 Years		DC-version	24V DC		3m		AC-version	100V 305V AC		3m
------	-----	-------	---------------------	------------	--	---------	--	------------	--------	--	----	--	------------	-----------------	--	----

LED light	Item no.	Arm length (A)	Base (B)	Optics	E <sub>max</sub> *	Luminous flux	Power	Connection
CENALED LENS Flex arm DC	121110-01	500 mm	59 mm	120°	4051 lx	1277 lm	-8.4 W	24V DC
CENALED LENS Flex arm AC	121110-11	500 mm	88 mm	120°	4051 lx	1277 lm	-9 W	100-305V AC

For 24V DC power supply units, see the Accessories page in the appendix

\* Maximum level of illumination at a distance of 250 cm

Accessories	Item no.
Magnetic clamp for CENALED screw-on base (holding force 600 N)	220500-01
Table clamp for CENALED screw-on base	220500-02
Wall bracket for CENALED screw-on base	220500-03



The CENALED LENS Flexarm forms part of the CENALED modular system. All housing parts are made of die-cast aluminium in solid industrial quality. The screw-on base for a 24V DC or 100-305V AC connection forms the basis of every light. The light is supplemented by an articulated arm, flex arm or directly mounted articulated head. The light head is the same in all versions and features an on/off switch and brightness control (dimming). The screw-on base can be combined with various mounting options, e.g. a magnetic clamp or table clamp.



## LED workplace lights with flex arms



### LED workplace light for wide-area illumination **CENALED FLOOD Flexarm**

The CENALED FLOOD Flexarm is a flexible LED work light for wide-area illumination of manual workstations, workbenches or machines. The screw-on base and light head are made of die-cast aluminium with safety glass over the light aperture. The flexible arm and head joint make it easy to position the light in any desired position and aim the light where it is needed. A magnetic clamp, table clamp and wall bracket are available as alternative mounting options for the screw-on base.

#### Technology

- High-power LED chips for daylight white light
- On/off switch and dimming via push-button on light head
- High-quality 500 mm gooseneck – highly flexible, tested for 20,000 bending cycles and fitted with an oil-resistant sheath
- Available as a 24V DC variant or for direct connection to 100–305V AC, each with a 3 m power cord

#### Your benefits

- Compact, powerful, wide-area light with excellent contrast and detail sharpness
- Flicker-free light with no UV or IR content
- Precise adjustment using bendable flex arm

#### Areas of application

- Manual workstations for goldsmiths or watchmakers
- Workstations on drilling, grinding and chipping machines
- Workbenches and testing workstations

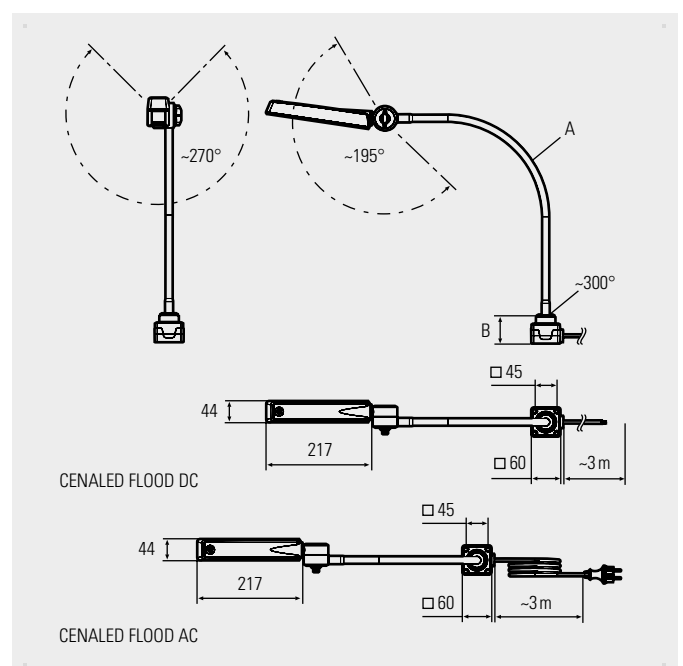



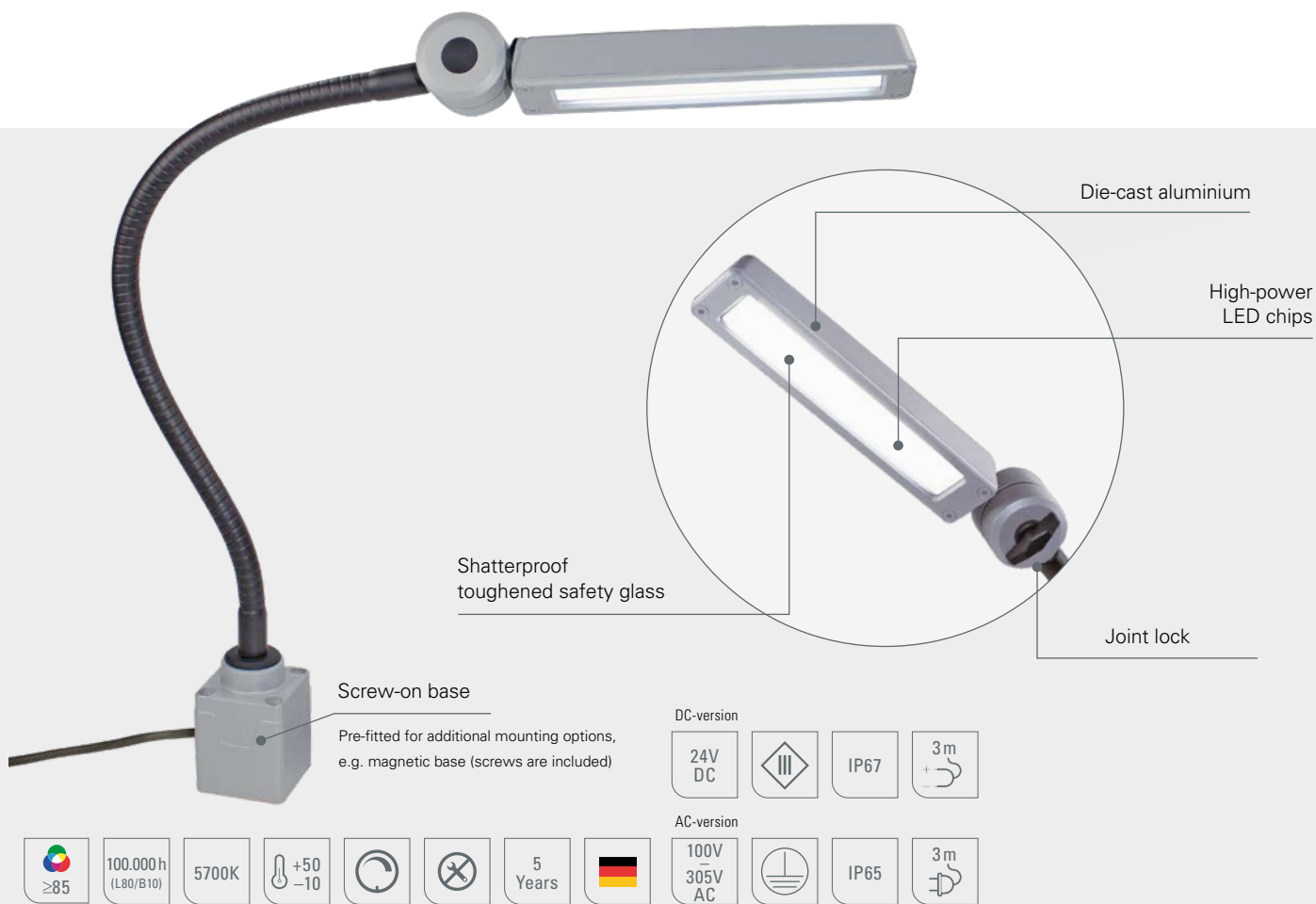

LED light	Item no.	Arm length (A)	Base (B)	Optics	$E_{max}^*$	Luminous flux	Power	Connection
CENALED FLOOD Flexarm DC	121210-01	500 mm	59 mm	118°	1641 lx	1260 lm	-8.4 W	24V DC
CENALED FLOOD Flexarm AC	121210-11	500 mm	88 mm	118°	1641 lx	1260 lm	-9 W	100-305V AC

For 24V DC power supply units, see the Accessories page in the appendix

\* Maximum level of illumination, measurement field 100 cm x 100 cm at a distance of 50 cm

Accessories	Item no.
Magnetic clamp for CENALED screw-on base (holding force 600 N)	220500-01
Table clamp for CENALED screw-on base	220500-02
Wall bracket for CENALED screw-on base	220500-03

The CENALED FLOOD Flexarm forms part of the CENALED modular system. All housing parts are made of die-cast aluminium in solid industrial quality. The screw-on base for a 24V DC or 100-305V AC connection forms the basis of every light. The light is supplemented by an articulated arm, flex arm or directly mounted articulated head. The light head is the same in all versions and features an on/off switch and brightness control (dimming). The screw-on base can be combined with various mounting options, e.g. a magnetic clamp or table clamp.





## LED workplace light for pinpoint illumination CENALED SPOT Articulated arm

The CENALED SPOT Articulated arm light is a precisely adjustable light for manual workstations and smaller machines. The generously sized aluminium articulated arm of this otherwise delicate-looking light guarantees a wide working radius to bring the light right to where it is needed. The smaller beam angle produces focussed illumination. The CENALED SPOT articulated arm LED workplace light is one of the few articulated arm lights that can also be used in metal-cutting applications thanks to its high degree of protection.

### Technology

- High-power LED chips for neutral white light
- On/off and dimmable using push-button on light head
- Far-reaching articulated arms made of aluminium, adjustable via joints and with protected, integrated power cords
- Connection, depending on variant, is 24V DC or 100–305V AC, each with a 3 m power cord

### Your benefits

- Sturdy LED light for powerful illumination in neutral white with excellent detail sharpness
- Flicker-free light with no UV or IR content
- Can be precisely adjusted using the articulated arm
- 30° beam angle for focused illumination

### Areas of application

- Workstations on machines, systems or in craft trades
- Goldsmiths, dental laboratories or watchmakers
- Workbenches and testing workstations
- Conventional machine tools

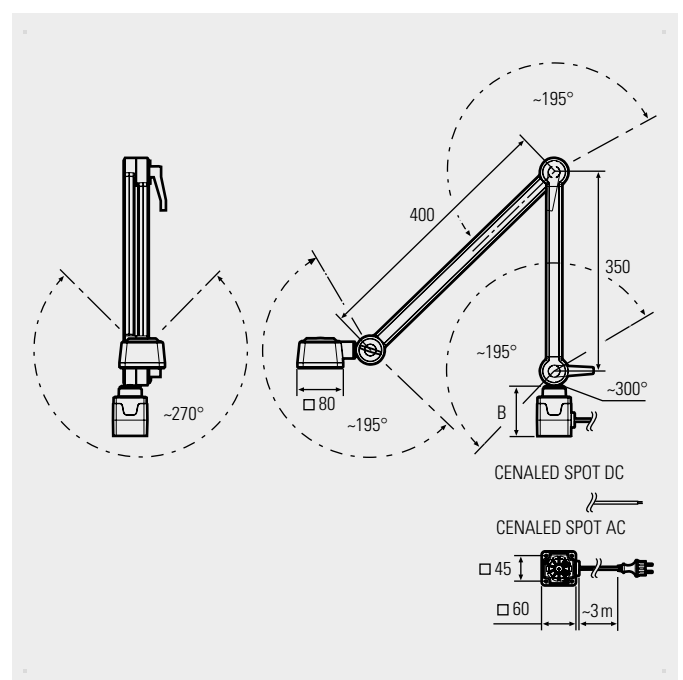

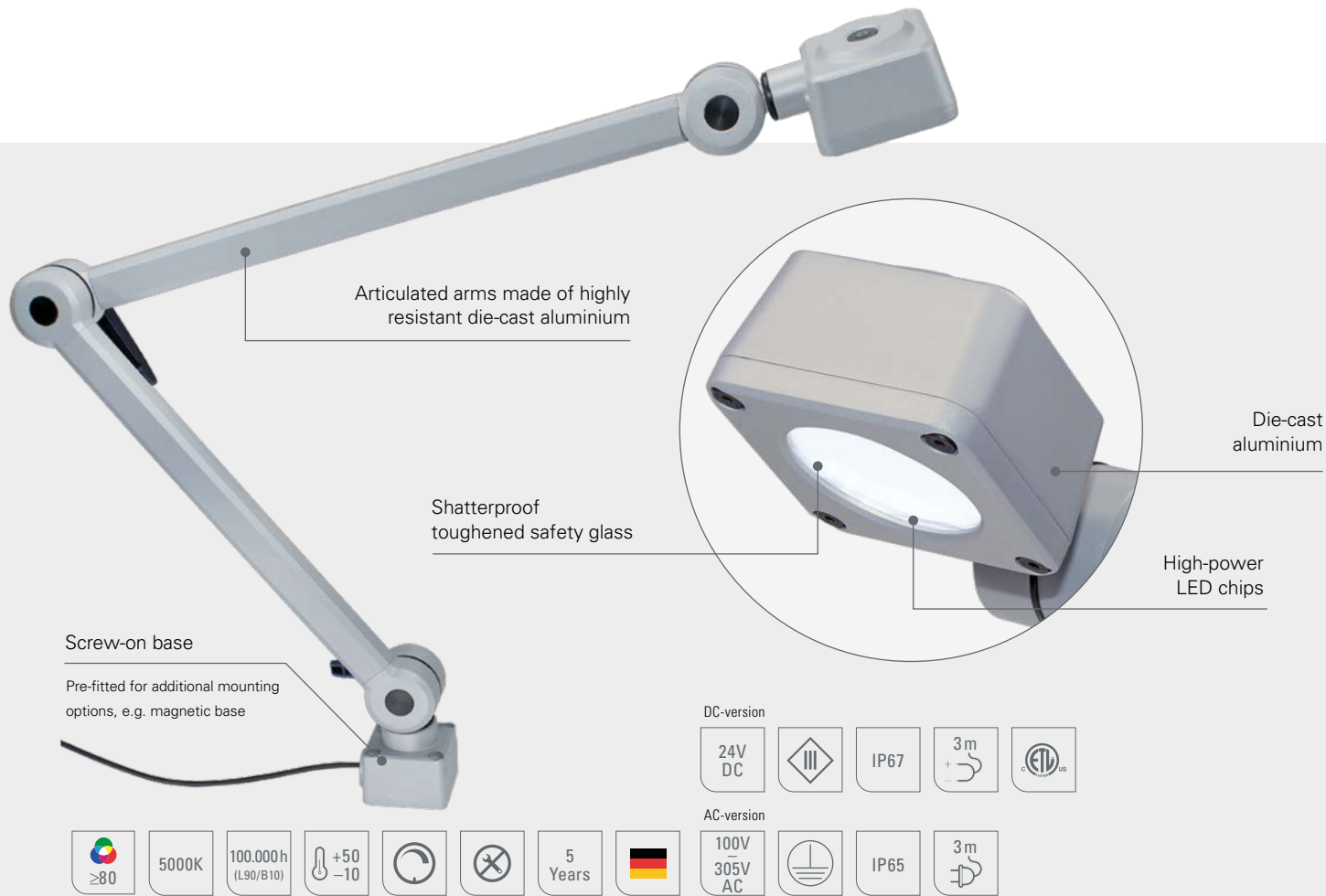

LED light	Item no.	Articulated arm length	Base (B)	Optics	E <sub>max</sub> *	Luminous flux	Power	Connection
CENALED SPOT Articulated arm DC	121012-02	750 mm	59 mm	30°	8584 lx	1120 lm	~8.5 W	24V DC
CENALED SPOT Articulated arm AC	121012-12	750 mm	88 mm	30°	8584 lx	1120 lm	~9 W	100–305V AC

For 24V DC power supply units, see the Accessories page in the appendix

\* Maximum level of illumination, measurement field 100 cm x 100 cm at a distance of 50 cm

Accessories	Item no.
Magnetic clamp for CENALED screw-on base (holding force 600 N)	220500-01
Table clamp for CENALED screw-on base	220500-02
Wall bracket for CENALED screw-on base	220500-03



The CENALED SPOT articulated arm is part of the CENALED modular system. All housing parts are made of die-cast aluminium in solid industrial quality. The screw-on base for a 24V DC or 100–305V AC connection forms the basis of every light. The light is supplemented by an articulated arm, flex arm or directly mounted articulated head. The light head is the same in all versions and features an on/off switch and brightness control (dimming). The screw-on base can be combined with various mounting options, e.g. a magnetic clamp or table clamp.







## LED magnifier light LENSLED II

The LENSLED II is the king of magnifying lights. Developed for stationary use at assembly or inspection workstations, the LED light with magnifying lens can be adjusted to the desired position using the aluminium spring arm. The scratch-resistant lens is made of glass and provides 1.85x magnification. The bright light for illuminating the magnified area is shadow-free, glare-free and the light intensity can be adjusted by means of continuous dimming.

### Technology

- Aluminium housing, aluminium spring arm, 3D head joint
- Head and spring arm can be swivelled and locked in position
- Magnifying lens with illuminated field of view, glass lens dia. 160 mm, 3.5 dpt, focal length ~286 mm
- Biconvex lens variant with additional embedded bifocal lens, dia. 31.5 mm, 8 dpt, focal length ~87 mm
- Universal power supply unit, table clamp and lens cover included

### Your benefits

- Scratch-resistant glass lens with high magnification level
- Powerful, glare-free and flicker-free illumination of the magnified area
- Flicker-free light with no UV or IR content
- The articulated arm and 3D head joint give you maximum flexibility for positioning the light
- Continuous dimming with memory function
- Optional accessories for a wide range of mounting options: e.g. wall bracket or bracket for T-slot profiles

### Areas of application

- Assembly and inspection workstations, manual workstations for goldsmiths, dental laboratories and watchmakers
- Test stations on machines

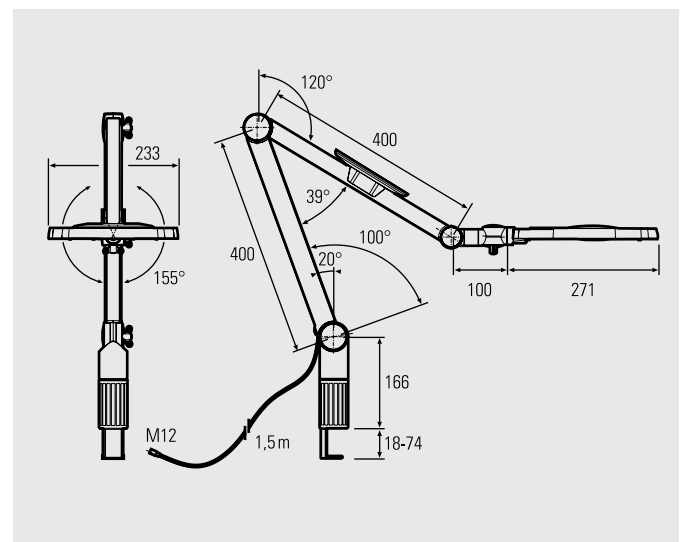



LED light	Item no.	Arm length	Optics	$E_{max}^*$	Luminous flux	Power	Connection
LENSLED II, 3.5 dpt., dimmable	120810-11	800 mm	120°	3821 lx	1570 lm	~15 W	24V DC**
LENSLED II, 3.5 dpt. + 8 dpt., dimmable	120810-12	800 mm	120°	3821 lx	1570 lm	~15 W	24V DC**

\*\*power supply 100-240V and table clamp in the scope of delivery

\* Maximum illumination, 286 mm distance

Accessories	Item no.
Articulated arm light wall bracket	215100-01
Articulated arm light adapter for T-slot profile	215200-01
Articulated arm light screw-on base 60 x 60 mm, plastic, screw dimensions 45 x 45 mm	215400-03





### LED articulated arm light UNILED II

The UNILED II LED articulated arm light combines functionality with powerful light output. The articulated arm technology makes it easy to position and fix the light head in any desired position. The light itself is available in coordinated versions: four power levels, two different light colours and coordinated articulated arms for special applications. There are also variants with integrated dimming. What they all have in common is excellent ergonomic handling and homogeneous, shadow-free and glare-free light for demanding visual tasks.

#### Technology

- State-of-the-art and energy-efficient LED technology
- High-quality articulated aluminium arm with a swivel and lockable light head featuring a 3D joint
- Aluminium head with heat dissipation to the rear

#### Your benefits

- Homogeneous, shadow-free and glare-free illumination
- Flicker-free light with no UV or IR content
- Choice of two white light colours
- Articulated arm and 3D head joint for maximum positioning flexibility and excellent ergonomic handling
- Light variants with long or short upper arm
- All variants also available with continuous dimming
- Wide range of mounting options with optional accessories

#### Areas of application

- For assembly and inspection workstations, manual workstations, goldsmiths, dental laboratories and watchmakers

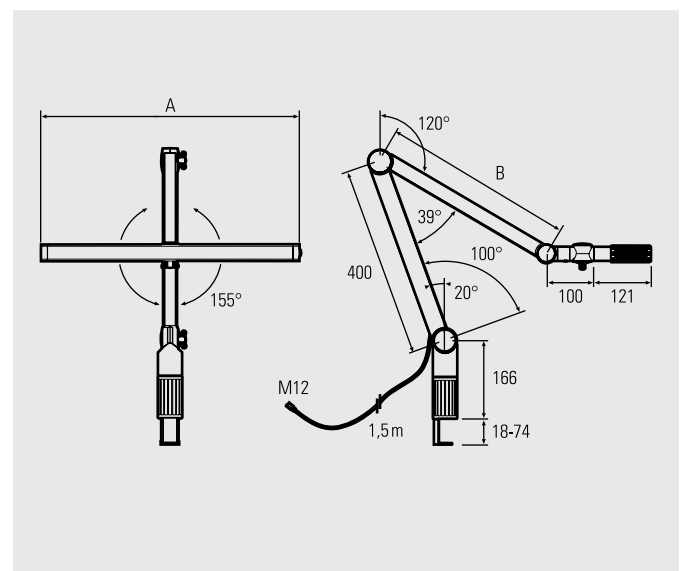



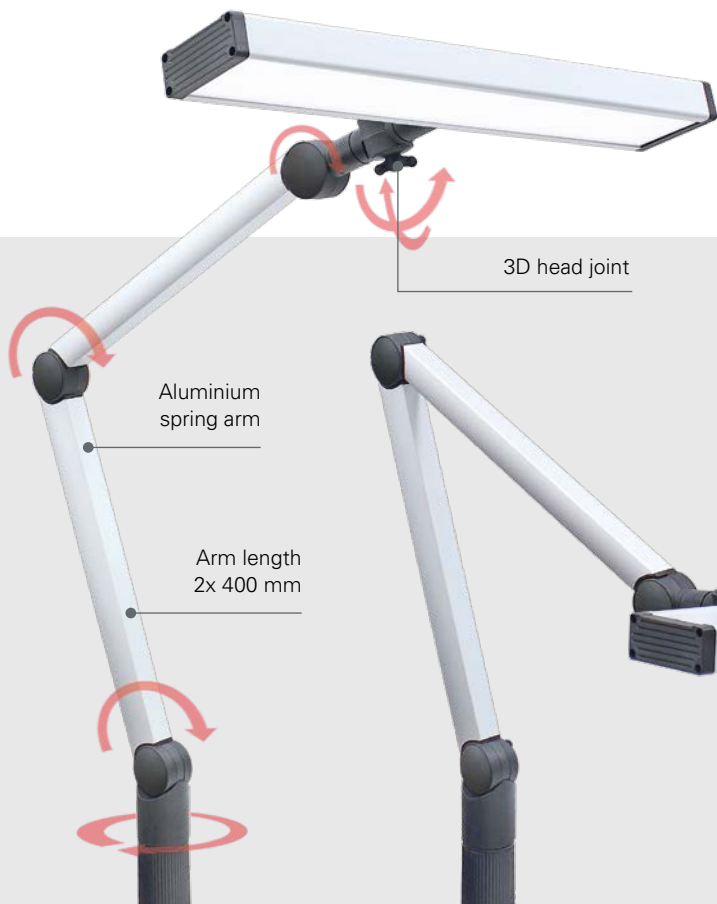

3D head joint

Aluminium spring arm

Arm length  
2x 400 mm



Shortened arm for tables  
up to 600 mm deep

Optional magnifying lens  
215500-01

UNILED II, head width 548 mm

UNILED II, head width 298 mm

UNILED II Watchmaker

24V DC
III
IP40
≥85
5700K
100.000 h (L80/B10)
M12
3m
+60 -10
Variant
5 Years
Germany
Power supply unit
100V - 240V AC

LED light	Item no.	Head width (A)	Arm (B)	Optics	E <sub>max</sub> *	Luminous flux	Power	Connection
UNILED II 5600K	120610-01	298 mm	400 mm	100°	2342 lx	1899 lm	~12 W	24V DC**
UNILED II 5600K, dimmable	120610-02	298 mm	400 mm	100°	2342 lx	1899 lm	~12 W	24V DC**
UNILED II 5600K	120710-01	548 mm	400 mm	100°	4249 lx	3798 lm	~25 W	24V DC**
UNILED II 5600K, dimmable	120710-02	548 mm	400 mm	100°	4249 lx	3798 lm	~25 W	24V DC**

LED light	Item no.	Head width (A)	Arm (B)	Optics	E <sub>max</sub> *	Luminous flux	Power	Connection
UNILED II 5600K Watchmaker	120910-01	380 mm	250 mm	100°	2563 lx	2531 lm	~16 W	24V DC**
UNILED II 5600K Watchmaker, dimmable	120910-02	380 mm	250 mm	100°	2563 lx	2531 lm	~16 W	24V DC**

Accessories	Item no.
Articulated arm light wall bracket	215100-01
Articulated arm light adapter for T-slot profile	215200-01
Articulated arm light screw-on base 60 x 60 mm, plastic, screw dimensions 45 x 45 mm	215400-03
UNILED II additional magnifying lens, 3.39 dpt.	215500-01





### LED articulated arm light **UNILED II TUNABLE WHITE**

Sunlight in the workplace. The light colour of the UNILED II TUNABLE WHITE is continuously adjustable and its colour rendering is almost identical to sunlight. This is known to have a very positive influence on the human organism. Light with this colour rendering also improves contrast and lets workers assess formed components in different light colours. An opal white glare shield over the LED chips produces homogeneous and shadow-free illumination of the work area. The LED light can be positioned anywhere in the workstation thanks to the aluminium spring arm.

#### Technology

- TRI-R LED chips for light with very high-fidelity colour rendering and a selection of colour temperatures
- Aluminium spring arm with 3D head joint
- High-quality articulated arm and light head can be swivelled and locked in any position even with one hand

#### Your benefits

- Homogeneous shadow-free and glare-free illumination
- Flicker-free light with no UV or IR content
- Continuous adjustment of colour temperature with an easy-to-use keypad on the light head: Choice of colour temperature from warm white to neutral white to daylight white
- High color fidelity and colour rendering up to  $R_a \geq 98$ , which is almost sunlight quality
- Promotes concentration and reduces signs of fatigue
- Excellent ergonomic handling
- All variants also available with continuous dimming

#### Areas of application

- For assembly and inspection workstations, goldsmiths, dental laboratories, watchmakers and quality control
- Different colour temperatures for assessing surfaces

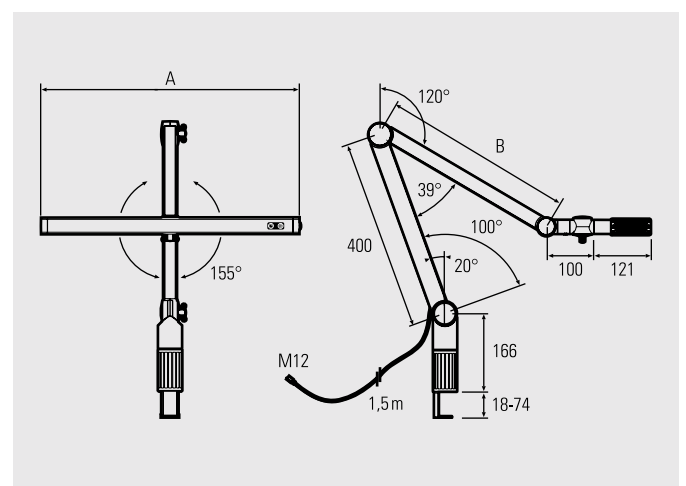

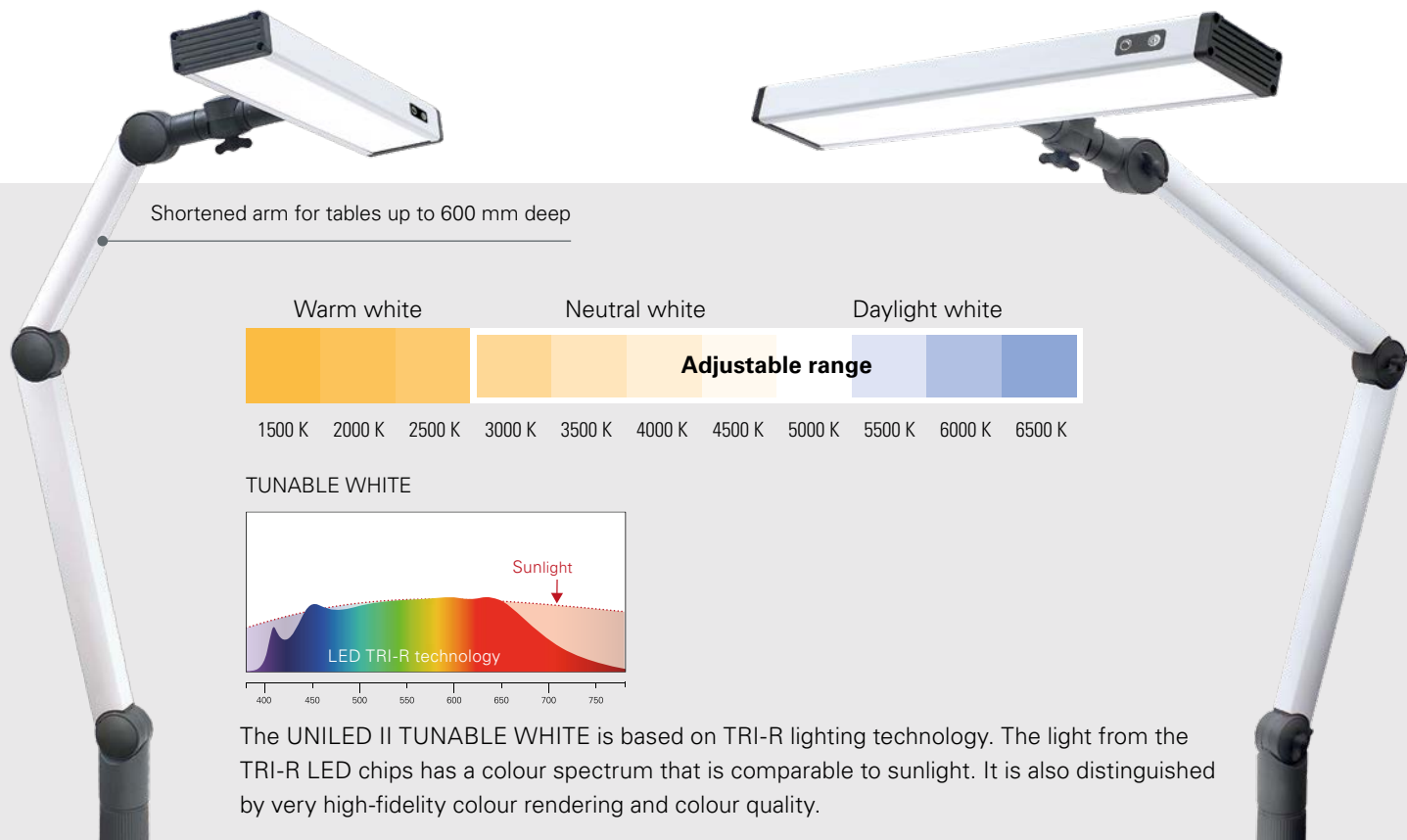

Shortened arm for tables up to 600 mm deep

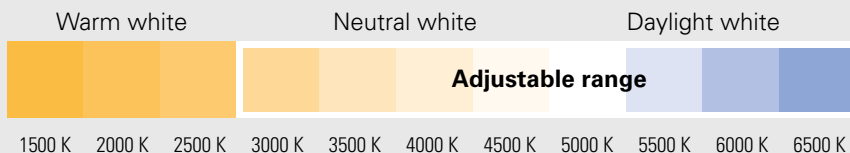

TUNABLE WHITE

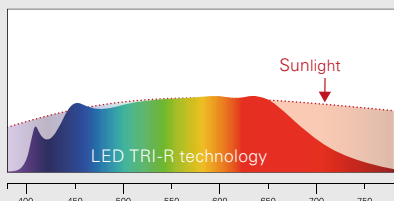

The UNILED II TUNABLE WHITE is based on TRI-R lighting technology. The light from the TRI-R LED chips has a colour spectrum that is comparable to sunlight. It is also distinguished by very high-fidelity colour rendering and colour quality.

UNILED II TUNABLE WHITE Watchmaker

UNILED II TUNABLE WHITE

24V DC
III
IP40
≥98
3000K 6500K
60.000h (L80/B10)
3m
+40 -10
Variant
5 Years
Germany
Power supply unit
100V 240V AC

LED light	Item no.	Head width (A)	Arm length (B)	Optics	Light colour	E <sub>max</sub> *	Luminous flux	Power	Connection
UNILED II TUNABLE WHITE	120700-01	548 mm	400 mm	100°	3000 K 6500 K	1995 lx 2279 lx	2244 lm 2418 lm	~25 W	24V DC**
UNILED II TUNABLE WHITE, dimmable	120700-02	548 mm	400 mm	100°	3000 K 6500 K	1995 lx 2279 lx	2244 lm 2418 lm	~25 W	24V DC**
UNILED II TUNABLE WHITE Watchmaker	120900-01	380 mm	250 mm	100°	3000 K 6500 K	1340 lx 1742 lx	1582 lm 1468 lm	~20 W	24V DC**
UNILED II TUNABLE WHITE Watchmaker, dimmable	120900-02	380 mm	250 mm	100°	3000 K 6500 K	1340 lx 1742 lx	1582 lm 1468 lm	~20 W	24V DC**

\*\*power supply 100-240V and table clamp in the scope of delivery

\* Maximum illumination, measurement field 100 cm x 100 cm at 50 cm distance

Accessories	Item no.
Articulated arm light wall bracket	215100-01
Articulated arm light adapter for T-slot profile	215200-01
Articulated arm light screw-on base 60 x 60 mm, plastic, screw dimensions 45 x 45 mm	215400-03
UNILED II additional magnifying lens, 3.39 dpt.	215500-01

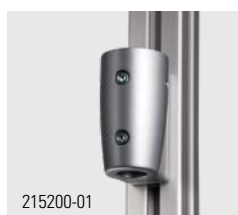





**WIDE RANGE power connection**

### LED system light **SYSTEMLED EVO**

The SYSTEMLED EVO LED system light sets new standards for modern lighting technology and design. The clean design of this LED system light blends seamlessly into any industrial environment. Full-surface light emission eliminates all dark areas and shadow lines. The result is very uniform, homogeneous illumination. Optimized glare control creates pleasant light without any annoying glare. The high-quality LED chips also guarantee excellent colour rendering. The SYSTEMLED EVO system light is available in five standard lengths and two wattage variants.

#### **Technology**

- Latest LED technology with light distribution across the entire light-emitting surface
- Shatter-resistant microprismatic cover
- Heat dissipation to the rear through the aluminium body
- Rear T-slot mounting for secure fixing to walls, ceilings or system workstations
- Connection via Wieland GST18i components
- All lights can be cascade-connected
- Dimming via optional accessories

#### **Versions**

- Five lengths: from 472 mm to 1782 mm, compatible with common system workstations
- Luminous-flux-optimised Power version or efficiency-optimised ECO version
- Light colour neutral white or daylight white

#### **Your benefits**

- Flicker-free light with no UV or IR content
- High light output and luminous efficacy of up to 184 lm/W
- CPC glare control with microprisms guarantees precise and homogeneous light control
- Glare-free illumination without reflections on surfaces: UGR value  $\leq 22$
- Excellent and stable colour rendering  $R_a \geq 90$  and high R9 values thanks to 3-step MacAdam binning of the LED chips
- All lights are cascadable
- Optional: Accessories available for switching, PWM dimming and brightness memory function
- The only light on the market that is 1782 mm long.

#### **Areas of application**

- Permanently installed lighting solution for system workstations, machines and systems

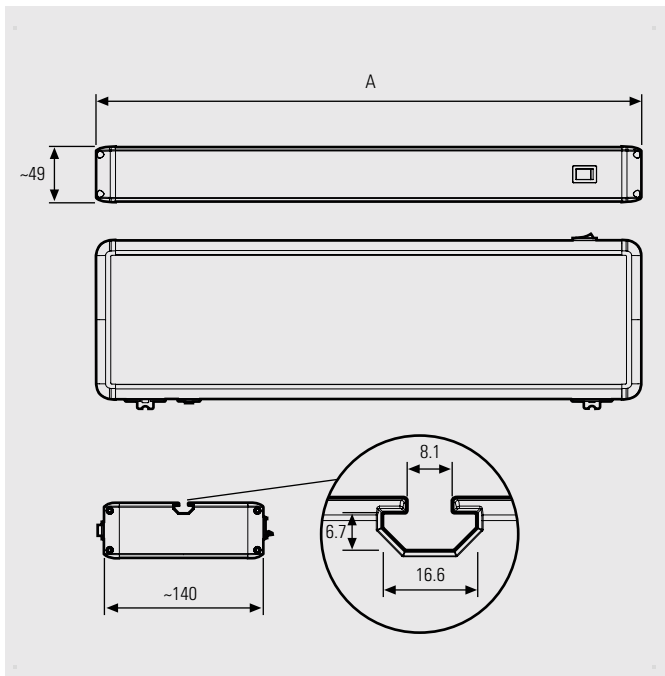

## LED system lights



Image © Bott GmbH & Co KG | www.bott.de

LED light	Item no.	Length (A)	Optics	$E_{max}^*$	Luminous flux	Power	Connection
SYSTEMLED EVO Power 5700K	155010-01	472 mm	90°	1239 lx	3250 lm	~21 W	120–277V AC
SYSTEMLED EVO Power 5700K	155110-01	898 mm	90°	2262 lx	6500 lm	~41 W	120–277V AC
SYSTEMLED EVO Power 5700K	155210-01	1120 mm	90°	2652 lx	8125 lm	~51 W	120–277V AC
SYSTEMLED EVO Power 5700K	155310-01	1342 mm	90°	2966 lx	9750 lm	~60 W	120–277V AC
SYSTEMLED EVO Power 5700K	155410-01	1782 mm	90°	3397 lx	13000 lm	~80 W	120–277V AC
SYSTEMLED EVO ECO 5700K	155010-02	472 mm	90°	739 lx	1990 lm	~13 W	120–277V AC
SYSTEMLED EVO ECO 5700K	155110-02	898 mm	90°	1350 lx	3980 lm	~26 W	120–277V AC
SYSTEMLED EVO ECO 5700K	155210-02	1120 mm	90°	1583 lx	4975 lm	~32 W	120–277V AC
SYSTEMLED EVO ECO 5700K	155310-02	1342 mm	90°	1770 lx	5970 lm	~38 W	120–277V AC
SYSTEMLED EVO ECO 5700K	155410-02	1782 mm	90°	2027 lx	7960 lm	~51 W	120–277V AC
SYSTEMLED EVO 4000K	155020-02	472 mm	90°	739 lx	1990 lm	~13 W	120–277V AC
SYSTEMLED EVO 4000K	155120-02	898 mm	90°	1350 lx	3980 lm	~26 W	120–277V AC
SYSTEMLED EVO 4000K	155220-02	1120 mm	90°	1583 lx	4975 lm	~32 W	120–277V AC
SYSTEMLED EVO 4000K	155320-02	1342 mm	90°	1770 lx	5970 lm	~38 W	120–277V AC
SYSTEMLED EVO 4000K	155420-02	1782 mm	90°	2027 lx	7960 lm	~51 W	120–277V AC

GST18i connection and connection material, code ■ in appendix

\* Maximum illumination, measuring field 100 cm x 100 cm at 100 cm distance

Multiple SYSTEMLED EVOs can be linked together (cascadable). Mains voltage is applied to the first light and all other lights are connected using Wieland extension cables and the inputs and outputs in the light housings. The total amperage of the interlinked lights must not exceed the fuse protection capacity of the operating-side connection.





#### Mounting accessories for SYSTEMLED EVO

	Item no.
Mounting kit, swivelling, ESD insulation ⚠️, 1 pair with T-nuts and screws	240400-02
Slim mounting kit, 1 pair with T-nuts and screws	240400-04
Slim mounting kit, ESD insulation ⚠️, 1 pair with T-nuts and screws	240400-05
Mounting kit for fixing to the front of a light up to 500 mm long, 1 mounting bracket with T-nuts and screws	240400-06
1 pair of T-nuts with screws for T-slot 8 (SYSTEMLED EVO)	240400-07

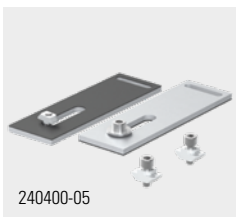

#### Lighting accessories

	Item no.
SYSTEMLED EVO control unit for switching and dimming, external, 3 m connection cable	240700-01
SYSTEMLED EVO control unit for switching and dimming, external, 5 m connection cable	240700-03
SYSTEMLED EVO external memory stick for saving the brightness level set using the control unit	240700-02





**WIDE RANGE power connection**

### LED system luminaire with PIR motion sensors **SYSTEMLED EVO PIR**

The SYSTEMLED EVO with integrated PIR module combines modern lighting technology and clean design with automatic lighting control. The full-surface light emission ensures uniform, homogeneous illumination without dark areas. Optimized glare control provides pleasant light without disturbing glare, while high-quality LED chips deliver very good colour rendering. The PIR module switches the luminaire on when movement is detected within the detection range and switches it off again after a freely adjustable period without activity; both the on-time and sensitivity can be individually adjusted.

#### Technology

- Latest LED technology with light distribution across the entire light-emitting surface
- Integrated PIR module with adjustable on-time and detection range for automatic light switching
- Shatter-resistant microprismatic cover
- Rear T-slot mounting for secure fixing to walls, ceilings or system workstations
- Connection via Wieland GST18i components
- All lights can be cascade-connected
- Dimming via optional accessories

#### Versions

- Five lengths: from 472 mm to 1782 mm, compatible with common system workstations
- Luminous-flux-optimised Power version or efficiency-optimised ECO version
- Light colour neutral white or daylight white

#### Your benefits

- Flicker-free light with no UV or IR content
- Automatic switching on and off in response to movement or inactivity via a PIR module with multiple sensors
- Soft start-up when switching on and coming-home function when transitioning to standby mode
- High light output and luminous efficacy of up to 184 lm/W
- CPC glare control with microprisms guarantees precise and homogeneous light control
- Glare-free illumination without reflections on surfaces: UGR value  $\leq 22$
- Excellent and stable colour rendering  $R_a \geq 90$  with high  $R9$  values
- Optional: Accessories available for switching, PWM dimming and brightness memory function
- The only light in this class available in a length of 1782 mm

#### Areas of application

- Permanently installed lighting solution for system workstations, assembly and inspection workstations, picking stations, as well as laboratories and cleanrooms



- WIDE RANGE  
120V  
277V  
AC
- 
- IP40
- ≥90
- 100.000h  
(L80/B10)
- GST18i
- +50  
-10
- Daylight white  
5700K
- Neutral white  
4000K
- low UGR  
optimized
- OPTION
- 
- 5 Years
- 

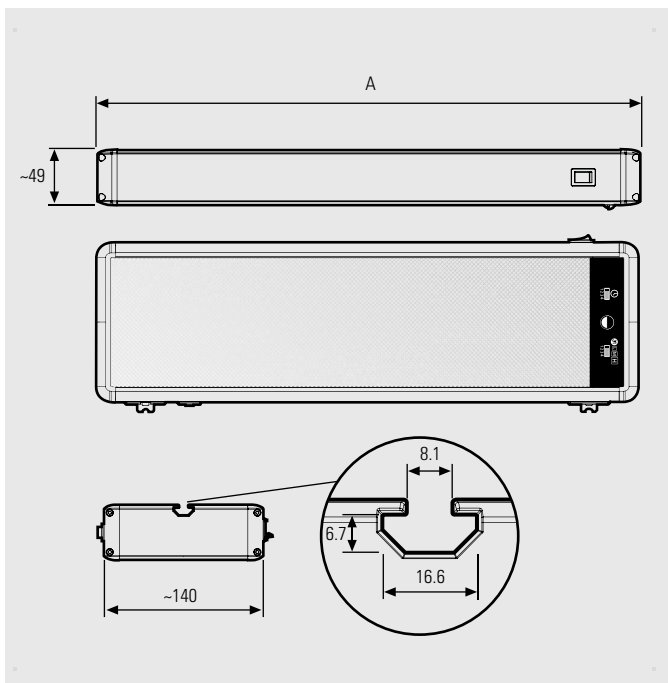



## LED system lights



Image © Bott GmbH & Co KG | www.bott.de

LED light	Item no.	Length (A)	Optics	$E_{max}^*$	Luminous flux	Power	Connection
SYSTEMLED EVO PIR Power 5700K	155010-03	472 mm	90°	1239 lx	3250 lm	~21 W	120-277V AC
SYSTEMLED EVO PIR Power 5700K	155110-03	898 mm	90°	2262 lx	6500 lm	~41 W	120-277V AC
SYSTEMLED EVO PIR Power 5700K	155210-03	1120 mm	90°	2652 lx	8125 lm	~51 W	120-277V AC
SYSTEMLED EVO PIR Power 5700K	155310-03	1342 mm	90°	2966 lx	9750 lm	~60 W	120-277V AC
SYSTEMLED EVO PIR Power 5700K	155410-03	1782 mm	90°	3397 lx	13000 lm	~80 W	120-277V AC
SYSTEMLED EVO PIR ECO 5700K	155010-04	472 mm	90°	739 lx	1990 lm	~13 W	120-277V AC
SYSTEMLED EVO PIR ECO 5700K	155110-04	898 mm	90°	1350 lx	3980 lm	~26 W	120-277V AC
SYSTEMLED EVO PIR ECO 5700K	155210-04	1120 mm	90°	1583 lx	4975 lm	~32 W	120-277V AC
SYSTEMLED EVO PIR ECO 5700K	155310-04	1342 mm	90°	1770 lx	5970 lm	~38 W	120-277V AC
SYSTEMLED EVO PIR ECO 5700K	155410-04	1782 mm	90°	2027 lx	7960 lm	~51 W	120-277V AC
SYSTEMLED EVO PIR 4000K	155020-04	472 mm	90°	739 lx	1990 lm	~13 W	120-277V AC
SYSTEMLED EVO PIR 4000K	155120-04	898 mm	90°	1350 lx	3980 lm	~26 W	120-277V AC
SYSTEMLED EVO PIR 4000K	155220-04	1120 mm	90°	1583 lx	4975 lm	~32 W	120-277V AC
SYSTEMLED EVO PIR 4000K	155320-04	1342 mm	90°	1770 lx	5970 lm	~38 W	120-277V AC
SYSTEMLED EVO PIR 4000K	155420-04	1782 mm	90°	2027 lx	7960 lm	~51 W	120-277V AC

GST18i connection and connection material, code ■ in appendix

\* Maximum illumination, measuring field 100 cm x 100 cm at 100 cm distance

Multiple SYSTEMLED EVOs can be linked together (cascadable). Mains voltage is applied to the first light and all other lights are connected using Wieland extension cables and the inputs and outputs in the light housings. The total amperage of the interlinked lights must not exceed the fuse protection capacity of the operating-side connection.

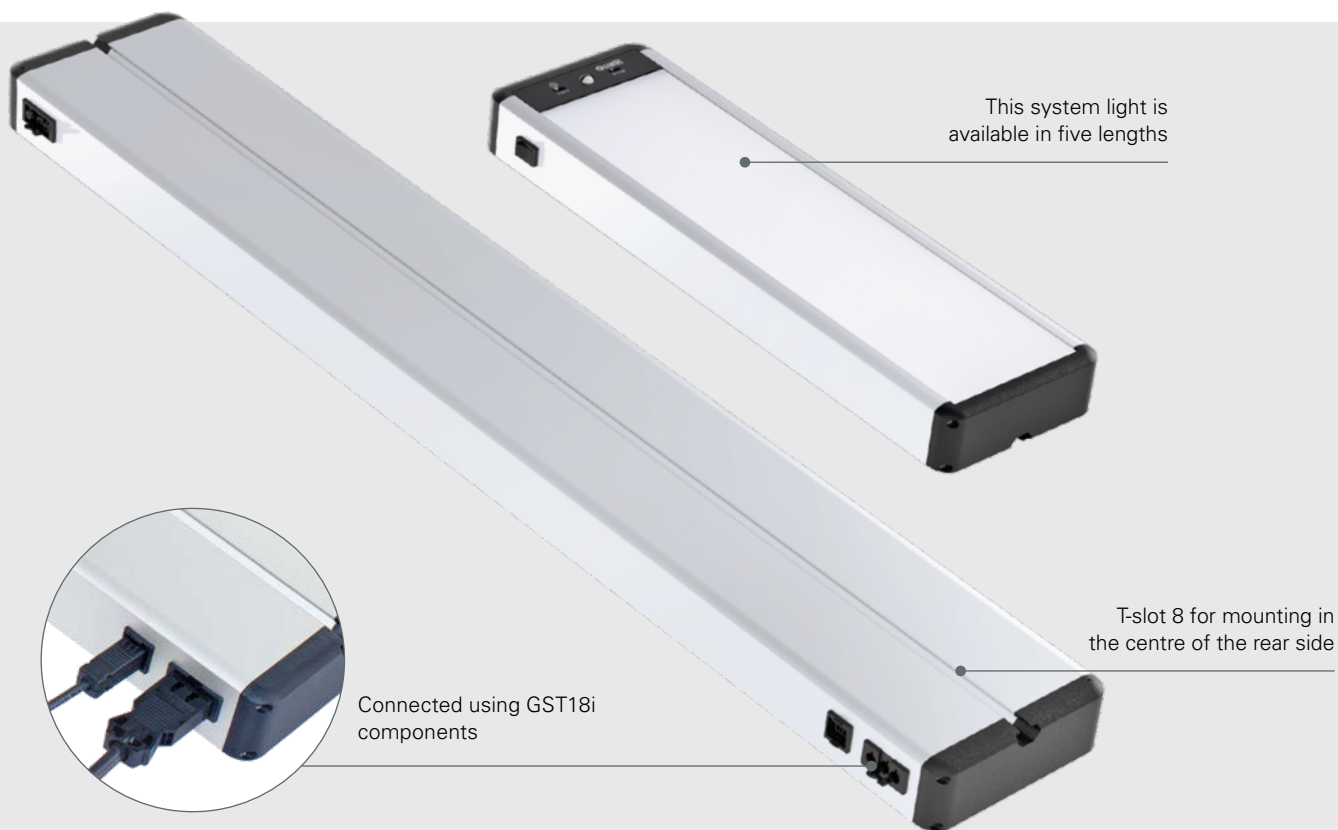

This system light is available in five lengths

T-slot 8 for mounting in the centre of the rear side

Connected using GST18i components

#### Mounting accessories for SYSTEMLED EVO

	Item no.
Mounting kit, swivelling, ESD insulation ⚠, 1 pair with T-nuts and screws	240400-02
Slim mounting kit, 1 pair with T-nuts and screws	240400-04
Slim mounting kit, ESD insulation ⚠, 1 pair with T-nuts and screws	240400-05
Mounting kit for fixing to the front of a light up to 500 mm long, 1 mounting bracket with T-nuts and screws	240400-06
1 pair of T-nuts with screws for T-slot 8 (SYSTEMLED EVO)	240400-07



#### Lighting accessories

	Item no.
SYSTEMLED EVO control unit for switching and dimming, external, 3 m connection cable	240700-01
SYSTEMLED EVO control unit for switching and dimming, external, 5 m connection cable	240700-03
SYSTEMLED EVO external memory stick for saving the brightness level set using the control unit	240700-02





WIDE RANGE power connection

## LED inspection workstation light with two colour temperatures SYSTEMLED SurfaceOne

Brings every detail to light: the SYSTEMLED SurfaceOne LED inspection workstation light provides uniform, glare-free illumination of predefined inspection areas. Different lighting scenarios make even the finest structures and surface differences visible. The light is ideal for surface inspections and visual quality control applications. The light segments of the different colour temperatures can be dimmed independently, allowing the lighting to be optimally adapted to each inspection task.

### Technology

- Full-surface illumination of each light segment
- Shatter-resistant microprismatic cover
- Rear T-slot mounting for brackets or mobile frames
- Connection via Wieland GST18i components
- Switching, control and dimming via an external control unit

### Your benefits

- Flicker-free light with no UV or IR content
- VDA 16-compliant inspection light
- Two colour temperatures, independently dimmable
- CPC glare control with microprisms guarantees precise and homogeneous light control
- High colour rendering with  $R_a \geq 90$  and high R9 values for reliable colour assessment

### Areas of application

- Surface inspection of coated or polished components
- Inspection stations in production lines
- Laboratory and development workstations

### Versions

- Two variants: 2x daylight white and 1x neutral white, or 2x daylight white and 2x neutral white; switchable alternately or across the entire light surface
- Three lengths: from 472 mm to 1120 mm

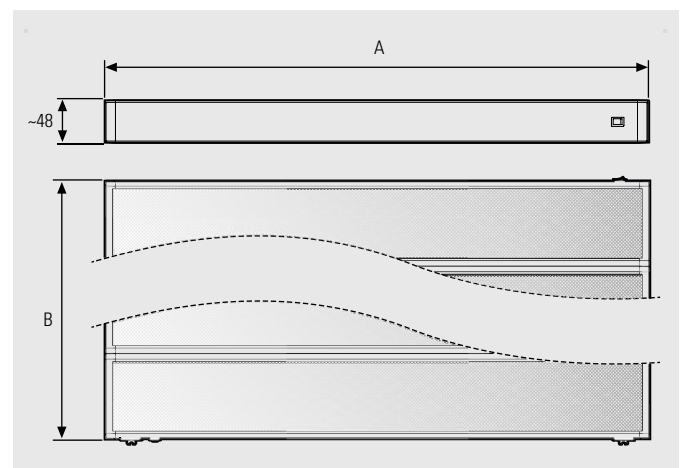



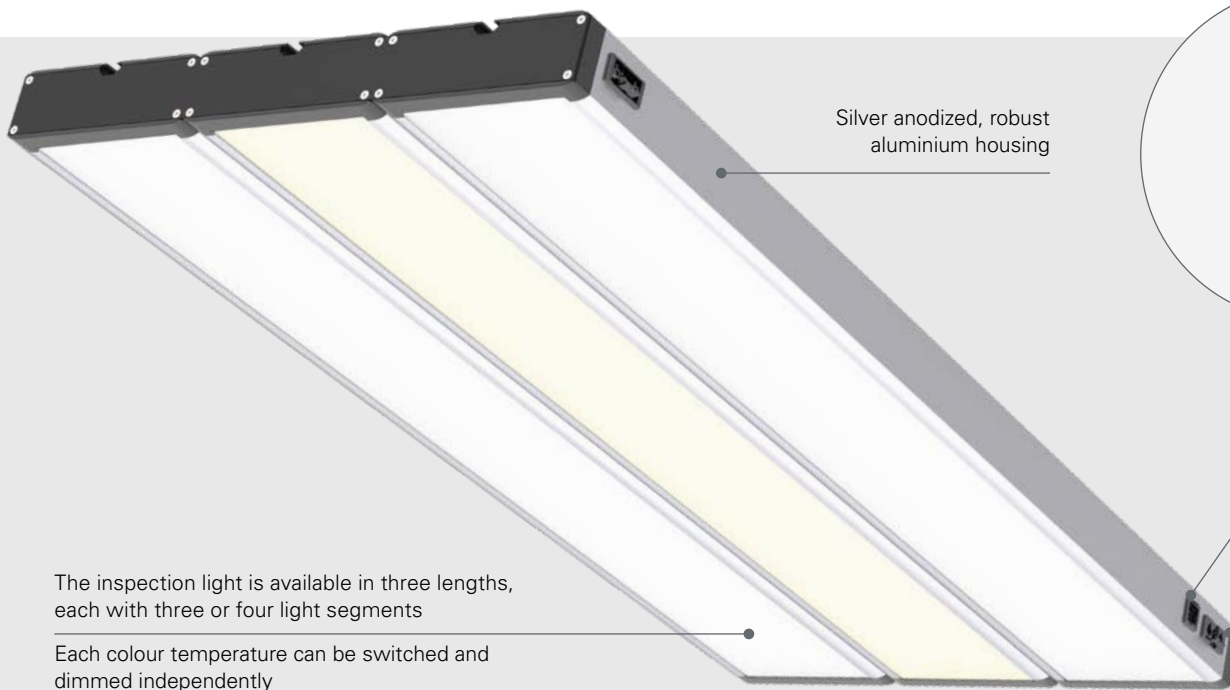

Ready-to-connect control unit included

Connected using GST18i components

The inspection light is available in three lengths, each with three or four light segments

Each colour temperature can be switched and dimmed independently

WIDE RANGE 120V 277V AC

IP40

≥90

100.000h (L80/B10)

GST18i

+50 -10

Daylight white 6500K

Neutral white 4000K

OPTION

5 Years

Germany

LED light	Item no.	Length (A)	Width (B)		[ 1 ]	[ 2 ]	[ 3 ]	[ 4 ]	Optics	Power	Connection
SYSTEMLED SurfaceOne   3x   472	155570-01	472 mm	417 mm	Colour temperature	6500K	4000K	6500K		90°	~38 W	120-277V AC
				$E_{max}^*$	739 lx	739 lx	739 lx				
				Luminous flux	1990 lm	1990 lm	1990 lm				
SYSTEMLED SurfaceOne   3x   898	155670-01	898 mm	417 mm	Colour temperature	6500K	4000K	6500K		90°	~75 W	120-277V AC
				$E_{max}^*$	1350 lx	1350 lx	1350 lx				
				Luminous flux	3980 lm	3980 lm	3980 lm				
SYSTEMLED SurfaceOne   3x   1120	155770-01	1120 mm	417 mm	Colour temperature	6500K	4000K	6500K		90°	~94 W	120-277V AC
				$E_{max}^*$	1583 lx	1583 lx	1583 lx				
				Luminous flux	4975 lm	4975 lm	4975 lm				
SYSTEMLED SurfaceOne   4x   472	155570-02	472 mm	556 mm	Colour temperature	6500K	4000K	6500K	4000K	90°	~51 W	120-277V AC
				$E_{max}^*$	739 lx	739 lx	739 lx	739 lx			
				Luminous flux	1990 lm	1990 lm	1990 lm	1990 lm			
SYSTEMLED SurfaceOne   4x   898	155670-02	898 mm	556 mm	Colour temperature	6500K	4000K	6500K	4000K	90°	~100 W	120-277V AC
				$E_{max}^*$	1350 lx	1350 lx	1350 lx	1350 lx			
				Luminous flux	3980 lm	3980 lm	3980 lm	3980 lm			
SYSTEMLED SurfaceOne   4x   1120	155770-02	1120 mm	556 mm	Colour temperature	6500K	4000K	6500K	4000K	90°	~124 W	120-277V AC
				$E_{max}^*$	1583 lx	1583 lx	1583 lx	1583 lx			
				Luminous flux	4975 lm	4975 lm	4975 lm	4975 lm			

GST18i connection and connection material, code ■ in appendix

\* Maximum illumination, measuring field 100 cm x 100 cm at 100 cm distance

Mounting accessories for SYSTEMLED EVO and SYSTEMLED SurfaceOne	Item no.
Mounting kit, swivelling, ESD insulation 🚧, 1 pair with T-nuts and screws	240400-02
Slim mounting kit, 1 pair with T-nuts and screws	240400-04
Slim mounting kit, ESD insulation 🚧, 1 pair with T-nuts and screws	240400-05
1 pair of T-nuts with screws for T-slot 8 (SYSTEMLED EVO)	240400-07



### LED system light UNILED SL DC

The UNILED SL DC LED light creates a pleasant and invigorating lighting atmosphere in system workstations. And that's not all. This LED workplace light has a matt cover that creates homogeneous, glare-free and shadow-free illumination with high light output. The UNILED SL DC is the perfect choice if you are looking for an economical system light with 24V DC connection and UL / CSA certification.

#### Technology

- Robust aluminium housing with integrated mounting brackets for horizontal installation
- Opal white, shatterproof and splinter-proof cover or micro-prismatic cover over the entire surface of the light aperture

#### Your benefits

- Creates an invigorating and pleasant atmosphere with daylight white light
- Powerful, homogeneous and low-shadow illumination
- UGR-optimised: Opal white cover for glare reduction or CPC glare control with microprisms
- Heat is dissipated to the rear via the aluminium body

#### Areas of application

- System and assembly workstations, test workstations
- Can be used in machines that do not use cooling lubricants and where there are no flying splinters from cutting
- Assembly lines

#### Versions

- Glare control in opal white or using microprisms
- Four lengths: 295 mm to 1545 mm

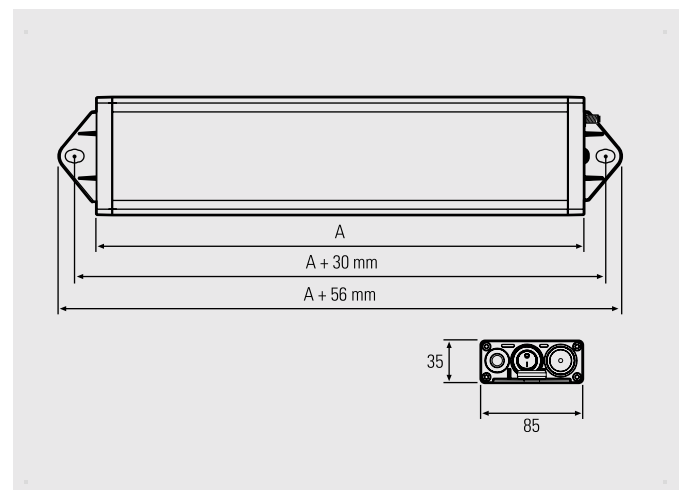



- 24V DC
- 
- IP50
- 
- 5700K
- 100.000 h (L80/B10)
- M12
- 
- low UGR optimized
- OPTION
- 
- 
- 5 Years
- 

LED light	Item no.	Length (A)	Optics	E <sub>max</sub> *	Luminous flux	Power	Connection
UNILED SL DC, opal white cover	110914-11	295 mm	100°	501 lx	1899 lm	~12 W	24V DC
UNILED SL DC, opal white cover	110914-12	545 mm	100°	966 lx	3798 lm	~24 W	24V DC
UNILED SL DC, opal white cover	110914-13	1045 mm	100°	1705 lx	7596 lm	~48 W	24V DC
UNILED SL DC, opal white cover	110914-14	1545 mm	100°	2180 lx	11394 lm	~72 W	24V DC
UNILED SL DC, microprism cover	110914-21	295 mm	100°	605 lx	1899 lm	~12 W	24V DC
UNILED SL DC, microprism cover	110914-22	545 mm	100°	1171 lx	3798 lm	~24 W	24V DC
UNILED SL DC, microprism cover	110914-23	1045 mm	100°	2086 lx	7596 lm	~48 W	24V DC
UNILED SL DC, microprism cover	110914-24	1545 mm	100°	2680 lx	11394 lm	~72 W	24V DC

For connection material, code ■, lighting accessories and power supply units, see accessories in appendix

\* Maximum illumination, measuring field 100 cm x 100 cm at 100 cm distance

Accessories	Item no.
UNILED SL light holder articulated bracket, 1 pair	210200-02







### LED system light with signal function UNILED SL RGB-W

UNILED SL RGB-W – a system light for lighting and signalling. The LED light sends signals using coloured light and illuminates the workplace directly with white light. The UNILED SL RGB-W LED light creates a pleasant, invigorating lighting atmosphere. The high light output of the LED technology is filtered through the matt, opal white cover. This creates homogeneous, glare-free and shadow-free illumination for system workstations or production facilities. Changes in status are clearly signalled by the light changing to coloured light.

#### Technology

- LED system light with LED chips arranged in clusters to generate white light and coloured light
- Robust aluminium housing with mounting lugs

#### Your benefits

- Two in one: flicker-free, neutral white lighting without UV and IR components and a free choice of signalling colours from the RGB colour space
- Homogeneous, low-shadow, glare-free illumination of work areas
- Coloured light can visibly signal changes to system workstations or production facilities from a distance

#### Areas of application

- System and assembly workstations, test workstations
- Can be used in machines that do not use cooling lubricants and where there are no flying splinters from cutting
- Assembly lines

#### Versions

- Four lengths: 295 mm to 1545 mm

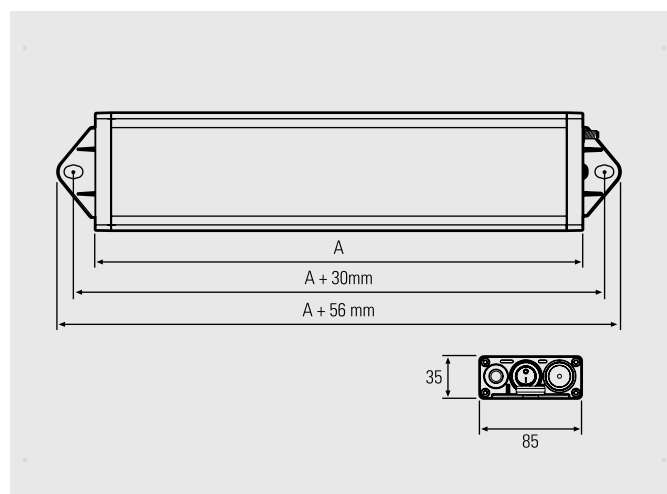



LED light	Item no.	Length (A)	Optics	E <sub>max</sub> * [W]	Luminous flux [W]	Power				Connection
						[R]	[G]	[B]	[W]	
UNILED SL RGB-W	110994-11	295 mm	100°	370 lx	1215 lm	~9 W	~2.5 W	~9 W	~9.5 W	24V DC
UNILED SL RGB-W	110994-12	545 mm	100°	714 lx	2430 lm	~18 W	~5 W	~18 W	~19 W	24V DC
UNILED SL RGB-W	110994-13	1045 mm	100°	1264 lx	4860 lm	~36 W	~10 W	~36 W	~38 W	24V DC
UNILED SL RGB-W	110994-14	1545 mm	100°	1616 lx	7290 lm	~54 W	~15 W	~54 W	~57 W	24V DC

For connection material, code ■, lighting accessories and power supply units, see accessories in appendix

\* Maximum illumination, measuring field 100 cm x 100 cm at 100 cm distance

Accessories	Item no.
UNILED SL light holder articulated bracket, 1 pair	210200-02





AC variant with WIDE RANGE voltage connection

### LED workplace and system light **PROFILED**

PROFILED was developed as a flexible workplace light. It is a powerful light for standard-compliant illumination of separate workstations and assembly areas. PROFILED LED light can also be used to illuminate systems, packing stations and workbenches. The microprism cover distributes light with precision. The light body gives you the option of mounting the LED light horizontally or vertically on a T-slot profile. With the version of the up and down adjustable pendant light is suspended from above and the light is adjusted to suit the work area by pulling down or pushing up.

#### Technology

- State-of-the-art LED technology with 24V DC or 120-277V AC for powerful illumination of work areas
- Microprisms and CPC geometry in the cover and robust aluminium profile housing with rear T-slot for mounting
- Up/down pendant light: height-adjustable ceiling suspension with spiral cable

#### Your benefits

- Powerful light in daylight white
- Homogeneous, glare-free illumination with minimal shadows
- UGR-optimised: CPC geometry and additional microstructure in the anti-glare cover provide precise light control, glare reduction and homogeneous light distribution

#### Areas of application

- System, assembly and separate workstations
- Packaging stations and storage areas
- Technical systems, test stations and workbenches
- Manual workstations in laboratories and in the dental and jewellery industries

#### Versions

- 24V DC with M12 plug connector or 120-277V AC direct connection using Wieland GST18i cable with mains plug or ceiling connection in the canopy of the up/down pendant
- Side ON/OFF switch plus variants with dimming push-button in the same place on the housing
- Five standard lengths (other lengths on request)



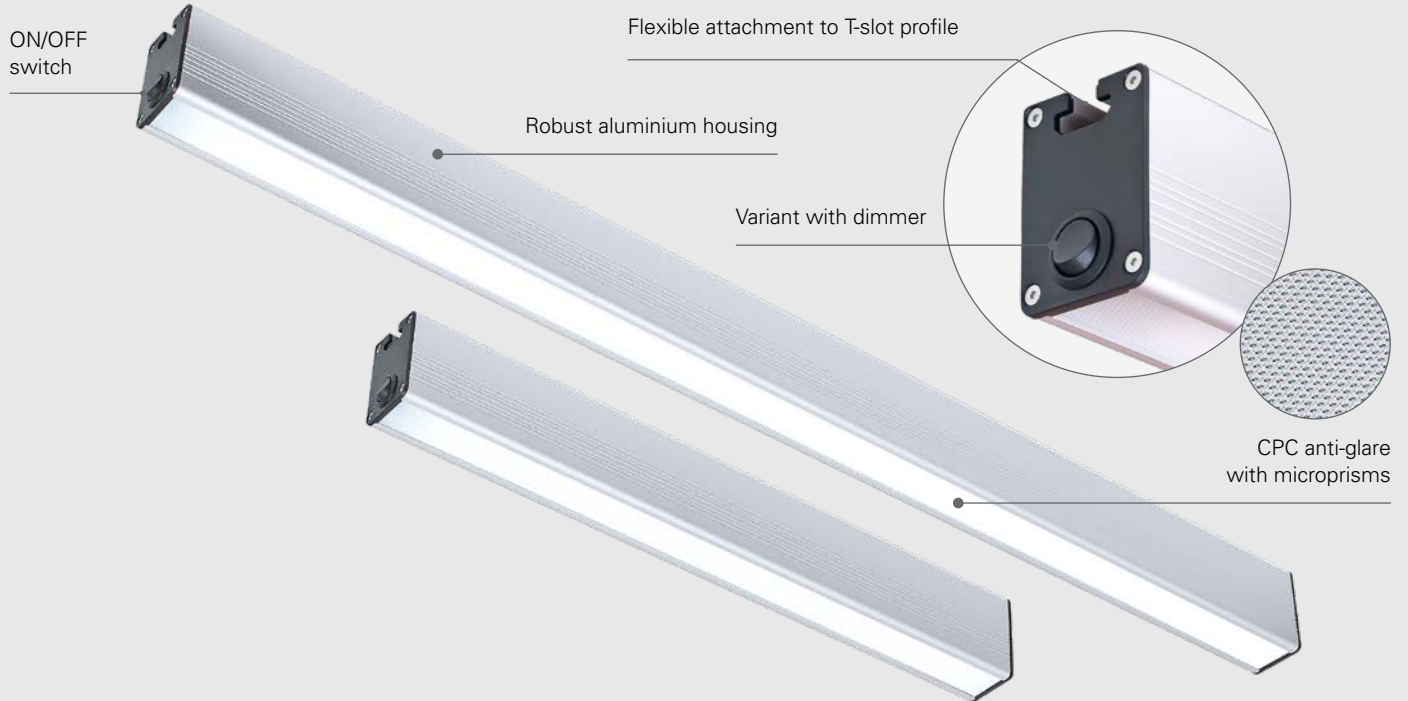

**PROFILED DC**



**PROFILED AC**

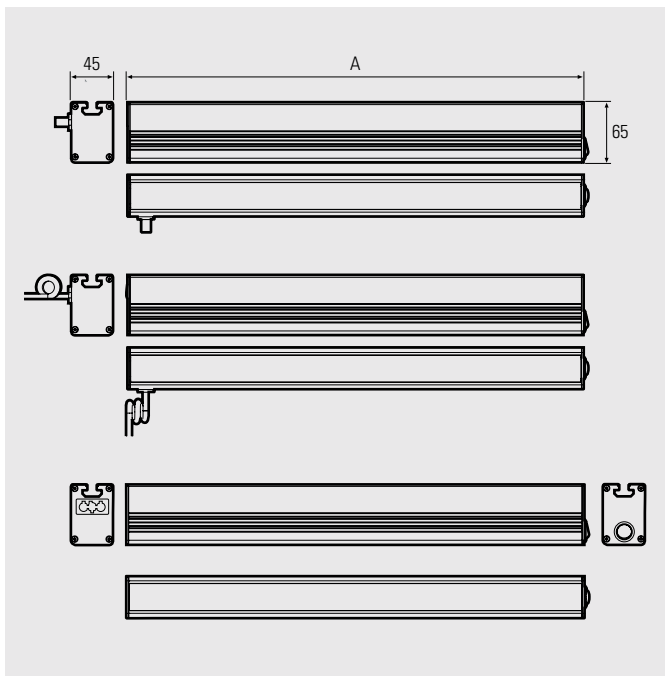

## LED workplace and system lights

LED system light with M12	Item no.	Length (A)	Optics	$E_{max}^*$	Luminous flux	Power	Connection	
PROFILED DC	150314-01	500 mm	100°	575 lx	1670 lm	~11 W	24V DC	M12-A sensor plug
PROFILED DC	150614-01	900 mm	100°	980 lx	3340 lm	~21 W	24V DC	M12-A sensor plug
PROFILED DC	150714-01	1000 mm	100°	1041 lx	3674 lm	~23 W	24V DC	M12-A sensor plug
PROFILED DC	150814-01	1200 mm	100°	1272 lx	4676 lm	~30 W	24V DC	M12-A sensor plug
PROFILED DC	150914-01	1500 mm	100°	TBA**	5678 lm	~37 W	24V DC	M12-A sensor plug
PROFILED DC, dimmable	150314-02	500 mm	100°	575 lx	1670 lm	~11 W	24V DC	M12-A sensor plug
PROFILED DC, dimmable	150614-02	900 mm	100°	980 lx	3340 lm	~21 W	24V DC	M12-A sensor plug
PROFILED DC, dimmable	150714-02	1000 mm	100°	1041 lx	3674 lm	~23 W	24V DC	M12-A sensor plug
PROFILED DC, dimmable	150814-02	1200 mm	100°	1272 lx	4676 lm	~30 W	24V DC	M12-A sensor plug
PROFILED DC, dimmable	150914-02	1500 mm	100°	TBA**	5678 lm	~37 W	24V DC	M12-A sensor plug

For connection material, code ■ and lighting accessories and PSU, see accessories in appendix

\* Maximum illumination level, measurement field 100 cm x 100 cm at distance of 100 cm | \*\*See data sheet for values

LED system lights with 3 m connection cable	Item no.	Length (A)	Optics	$E_{max}^*$	Luminous flux	Power	Connection	
PROFILED AC	150314-03	500 mm	100°	575 lx	1670 lm	~14 W	120–277V AC	3 m cable and mains plug
PROFILED AC	150614-03	900 mm	100°	980 lx	3340 lm	~24 W	120–277V AC	3 m cable and mains plug
PROFILED AC	150714-03	1000 mm	100°	1041 lx	3674 lm	~27 W	120–277V AC	3 m cable and mains plug
PROFILED AC	150814-03	1200 mm	100°	1272 lx	4676 lm	~34 W	120–277V AC	3 m cable and mains plug
PROFILED AC	150914-03	1500 mm	100°	TBA**	5678 lm	~39 W	120–277V AC	3 m cable and mains plug
PROFILED AC, dimmable	150314-04	500 mm	100°	575 lx	1670 lm	~14 W	120–277V AC	3 m cable and mains plug
PROFILED AC, dimmable	150614-04	900 mm	100°	980 lx	3340 lm	~24 W	120–277V AC	3 m cable and mains plug
PROFILED AC, dimmable	150714-04	1000 mm	100°	1041 lx	3674 lm	~27 W	120–277V AC	3 m cable and mains plug
PROFILED AC, dimmable	150814-04	1200 mm	100°	1272 lx	4676 lm	~34 W	120–277V AC	3 m cable and mains plug
PROFILED AC, dimmable	150914-04	1500 mm	100°	TBA**	5678 lm	~39 W	120–277V AC	3 m cable and mains plug

\* Maximum illumination level, measurement field 100 cm x 100 cm at distance of 100 cm | \*\*See data sheet for values

LED light with adjustable pull pendant	Item no.	Length (A)	Optics	$E_{max}^*$	Luminous flux	Power	Connection	
PROFILED AC adjustable pull pendant	150714-05	1000 mm	100°	1041 lx	3674 lm	~27 W	120–277V AC	Top suspension
PROFILED AC adjustable pull pendant	150814-05	1200 mm	100°	1272 lx	4676 lm	~34 W	120–277V AC	Top suspension
PROFILED AC adjustable pull pendant, dimmable	150714-06	1000 mm	100°	1041 lx	3674 lm	~27 W	120–277V AC	Top suspension
PROFILED AC adjustable pull pendant, dimmable	150814-06	1200 mm	100°	1272 lx	4676 lm	~34 W	120–277V AC	Top suspension

\* Maximum illumination level, measurement field 100 cm x 100 cm at distance of 100 cm

LED system light with Wieland GST18i	Item no.	Length (A)	Optics	$E_{max}^*$	Luminous flux	Power	Connection	
PROFILED AC	150314-07	500 mm	100°	575 lx	1670 lm	~14 W	120–277V AC	GST18i
PROFILED AC	150614-07	900 mm	100°	980 lx	3340 lm	~24 W	120–277V AC	GST18i
PROFILED AC	150714-07	1000 mm	100°	1041 lx	3674 lm	~27 W	120–277V AC	GST18i
PROFILED AC	150814-07	1200 mm	100°	1272 lx	4676 lm	~34 W	120–277V AC	GST18i
PROFILED AC	150914-07	1500 mm	100°	TBA**	5678 lm	~39 W	120–277V AC	GST18i
PROFILED AC, dimmable	150314-08	500 mm	100°	575 lx	1670 lm	~14 W	120–277V AC	GST18i
PROFILED AC, dimmable	150614-08	900 mm	100°	980 lx	3340 lm	~24 W	120–277V AC	GST18i
PROFILED AC, dimmable	150714-08	1000 mm	100°	1041 lx	3674 lm	~27 W	120–277V AC	GST18i
PROFILED AC, dimmable	150814-08	1200 mm	100°	1272 lx	4676 lm	~34 W	120–277V AC	GST18i
PROFILED AC, dimmable	150914-08	1500 mm	100°	TBA**	5678 lm	~39 W	120–277V AC	GST18i

For GST18i connection material, code ■ see accessories in appendix

\* Maximum illumination level, measurement field 100 cm x 100 cm at distance of 100 cm | \*\*See data sheet for values

Mounting accessories	Item no.
Mounting kit, swivelling, ESD insulation 🛡️, 1 pair with T-nuts and screws	240400-02
1 pair of T-nuts with screws for T-slot 10 (PROFILED)	240400-03
Slim mounting kit, 1 pair with T-nuts and screws	240400-04
Slim mounting kit, ESD insulation 🛡️, 1 pair with T-nuts and screws	240400-05
Mounting kit for fixing to the front of a light up to 500 mm long, 1 mounting bracket with T-nuts and screws	240400-06

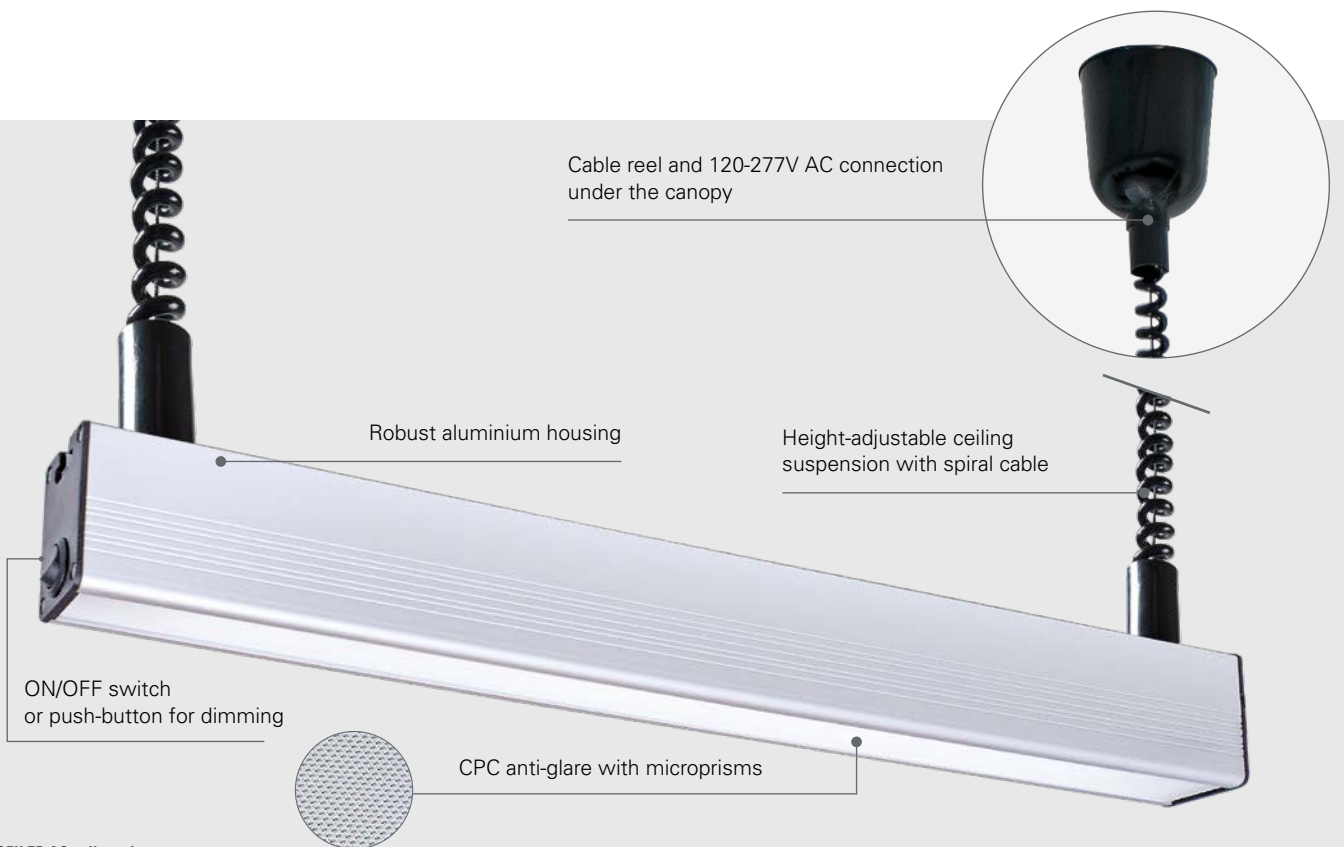

**PROFILED AC pull pendant**

WIDE RANGE 120V 277V AC				IP40		5700K	100.000 h (L80/B10)		5 Years	
----------------------------------	--	--	--	------	--	-------	------------------------	--	------------	--

The PROFILED AC LED workplace light with adjustable pull pendant can be used to vary the intensity of the light in a work area by pulling it down or pushing it up. Once the light has been suspended, it can be pulled down from 900 mm to 1800 mm on the up/down pendant fitting.

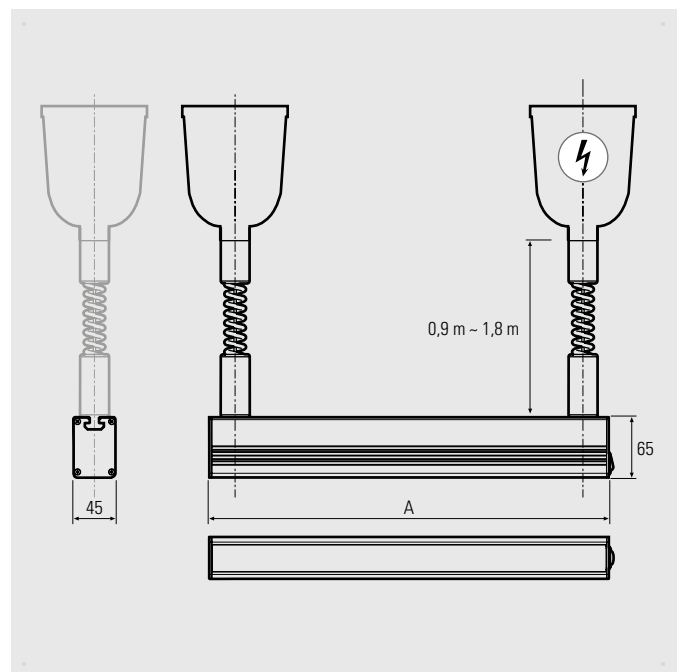



## Accessories

### Power connection of LED lights

Item	Item no.		Length of power cord	Cable material	Version	Operating voltage
Sensor cable M12, 4-wire	200100-01	■	5 m	PUR	M12 socket/M12 plug, A-coded	24V DC
Sensor cable M12, 4-wire	200100-02	■	2.5 m	PUR	M12 socket/M12 plug, A-coded	24V DC
Sensor cable M12, 4-wire	200100-03	■	10 m	PUR	M12 socket/M12 plug, A-coded	24V DC
Sensor cable M12, 4-wire	200100-04	■	5 m	PUR	M12 socket/open cable ends, 4-wire, A-coded	24V DC
Sensor cable M12, 4-wire	200100-05	■	2.5 m	PUR	M12 socket/open cable ends, 4-wire, A-coded	24V DC
Sensor cable M12, 4-wire	200100-06	■	10 m	PUR	M12 socket/open cable ends, 4-wire, A-coded	24V DC
Sensor cable M12, 4-wire	200100-07	■	5 m	PUR	M12 socket, angled/open cable ends, 4-wire, A-coded	24V DC
Sensor cable M12, 5-wire	200100-09	■	2.5 m	PUR	M12 socket/open cable ends, 5-wire, A-coded	24V DC
Sensor cable M12, 5-wire	200100-10	■	5 m	PUR	M12 socket/open cable ends, 5-wire, A-coded	24V DC
Sensor cable M12, 5-wire	200100-11	■	10 m	PUR	M12 socket/open cable ends, 5-wire, A-coded	24V DC

### Customisable plug connectors

Item	Item no.		Version	Operating voltage
M12 socket, 4-wire	200200-01	■	M12 socket, straight, 4-pin, A-coded, customisable	24V DC
M12 socket, 4-wire	200200-02	■	M12 socket, angled, 4-pin, A-coded, customisable	24V DC
Plug M12, 4-pin	200200-04	■	M12 plug, straight, 4-pin, A-coded, customisable	24V DC
Plug M12, 4-pin	200200-05	■	M12 plug, angled, 4-pin, A-coded, customisable	24V DC

### Distributors, adapters and others

Item	Item no.		Version	Operating voltage
T-distributor M12	200200-03	■	M12 T-piece, A-coded	24V DC
Protective plug M12	200200-06		Cover for M12 socket	24V DC
T-Verteiler M12	200200-07	■	M12 T-Stück, 1x M12 Stecker auf 2x M12 Buchse, 3-polig, max. 8 A	24V DC
Y-distributor M12	200200-08	■	1x M12 plug on 2x 1 m cables with M12 socket, 3-wire, max. 4 A	24V DC
Y-distributor M12	200200-09	■	1x M12 plug on 2x 2 m cables with M12 socket, 5-wire, max. 4 A	24V DC
Sensor/actuator box M12	200300-01	■	Sensor/actuator box with connection cable, 4 slots, A-coded, max. 4 A	24V DC
Türkontaktschalter	210800-01	■	Türkontaktschalter M12 Stecker / M12 Buchse, max. 4 A	24V DC

### Dimmer and lighting accessories for 24V DC lights

Item	Item no.	Protection rating	Current	Input voltage	Power
DIMM module, external, M12-A plug/socket (except RGB)	210700-04	IP40	max. 6 A	24V DC	~144 W
PWM module, external, M12-A plug/socket	210700-05	IP40	max. 4 A	24V DC	~96 W
DIMM module, external, M12-A plug/socket with 3 m connection cable (except RGB)	210700-06	IP54	max. 4 A	24V DC	~96 W
PIR sensor, external, M12-A plug/socket	210700-07	IP54	max. 4 A	24V DC	~96 W
DIMM module, external, M12-A plug/socket, for RGB-W	210700-08	IP54	max. 4 A	24V DC	~96 W

### Connection accessories for SYSTEMLED EVO and PROFILED AC GST18i

Item	Item no.		Version	Operating voltage
Wieland GST18i socket / mains plug cable, 5 m	240100-01	■	GST18i connection cable for power supply – ready for connection	220... 240V AC
Wieland GST18i socket / mains plug cable, 3 m	240100-02	■	GST18i connection cable for power supply – ready for connection	220... 240V AC
Wieland GST18i CH socket / mains plug cable, 5 m	240100-03	■	GST18i connection cable for power supply – ready for connection in Switzerland	220... 240V AC
Wieland GST18i socket / open ends cable, 5 m	240200-01	■	GST18i connection cable for power supply – customisable	220... 240V AC
Wieland GST18i extension cable, 1 m	240300-01	■	Connection cable for electrical linking (cascading) – only SYSTEMLED EVO	220... 240V AC
Wieland GST18i extension cable, 2 m	240300-02	■	Connection cable for electrical linking (cascading) – only SYSTEMLED EVO	220... 240V AC
Wieland GST18i extension cable, 5 m	240300-03	■	Connection cable for electrical linking (cascading) – only SYSTEMLED EVO	220... 240V AC

## Lighting accessories for SYSTEMLED EVO

Accessories	Item no.
SYSTEMLED EVO control unit for switching and dimming, external, with 3 m connection cable (not compatible with SYSTEMLED SurfaceOne)	240700-01
SYSTEMLED EVO control unit for switching and dimming, external, 5 m connection cable (not compatible with SYSTEMLED SurfaceOne)	240700-03
SYSTEMLED EVO external memory stick for saving the brightness level set using the control unit	240700-02

## Keep up to date!

You can find more information, data sheets and figures about our accessories here:

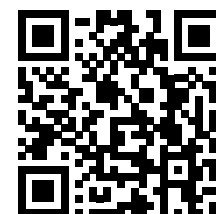

<https://shop.led2work.com> >>> Product accessories

















## Operating equipment with fixed voltage

LED drivers	Item no.	Power consumption	Input voltage	Output voltage	Version
Top-hat rail power supply unit	210100-01	~72 W	88... 264V AC	24V DC	–
Table power supply unit, M12 socket	210100-02	~60 W	90... 264V AC	24V DC	M12-A
Plug power supply unit, M12 socket, protection class II	210100-03	~36 W	100... 240V AC	24V DC	M12-A
Top-hat rail power supply unit	210100-04	~480 W	90... 264V AC	24V DC	–
Table power supply unit, M12 socket	210100-05	~120 W	90... 264V AC	24V DC	M12-A
Switching power supply unit, IP67, M12 socket, open ends	210100-06	~60 W	90... 305V AC	24V DC	M12-A
Switching power supply unit, IP67, M12 socket, open ends	210100-07	~100 W	90... 305V AC	24V DC	M12-A
Switching power supply unit, IP67, M12 socket, open ends	210100-08	~150 W	90... 305V AC	24V DC	M12-A
Top-hat rail power supply unit	210100-09	~120 W	88... 264V AC	24V DC	–
Top-hat rail power supply unit	210100-10	~240 W	88... 264V AC	24V DC	–
Switching power supply unit, M12 socket, protection class II	210100-11	~60 W	100... 240V AC	24V DC	M12-A
Table power supply unit, M12 socket, 5 m connection cable	210100-12	~60 W	90... 264V AC	24V DC	M12-A
Plug PSU, M12 socket, angled, protection class II	210100-13	~36 W	100... 240V AC	24V DC	M12-A
Top-hat rail PSU, protection class II   NEC class 2	210100-14	~100 W	88... 264V AC	24V DC	–
Switching power supply unit, IP67, M12 socket, open ends	210100-15	~240 W	90... 305V AC	24V DC	M12-A
Plug power supply unit, M12 socket, protection class II	210100-16	~60 W	90... 264V AC	24V DC	M12-A
Plug PSU, interchangeable adapter, M12 socket, protection class II	210100-17	~40 W	90... 264V AC	24V DC	M12-A

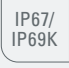
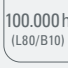
## Holders and mounting brackets

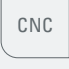
Light holders	Item no.
UNILED SL articulated bracket, 1 pair	213200-02
Mounting accessories, cable suspension for lights with T-slot profile: 2x wire cables, nickel-plated, 3 m, dia. 1.5 mm, with cylinder nipple on one end (can be shortened on site), 2x ceiling fastening set, 2x grippers (wire cable holder) with knurling and M6 external thread, 8 mm long (requires 1 pair of T-nuts with M6 internal thread)	213300-02
UNILED II / LENSLED II Articulated arm light wall bracket	215100-01
UNILED II / LENSLED II Articulated arm light adapter for T-slot profile	215200-01
UNILED II / LENSLED II Articulated arm light screw-on base, plastic (for existing screws with screw dimensions 60 x 60 mm)	215400-03
CENALED holding magnet for screw-on base (holding force 600 N)	220500-01
CENALED table clamp for screw-on base	220500-02
CENALED wall bracket for screw-on base	220500-03
SYSTEMLED EVO / PROFILED mounting kit, swivelling, ESD insulation  , 1 pair with T-nuts and screws	240400-02
1 pair T-nuts with screws for T-slot 10 for PROFILED	240400-03
PROFILED slim mounting kit, 1 pair with T-nuts and screws	240400-04
SYSTEMLED EVO / PROFILED slim mounting kit, ESD insulation  , 1 pair with T-nuts and screws	240400-05
SYSTEMLED EVO / PROFILED mounting kit, for fixing to the front of a light up to 500 mm long, 1 mounting bracket with T-nuts and screws	240400-06
1 pair T-nuts with screws for T-slot 8 for SYSTEMLED EVO	240400-07

## Explanation of symbols

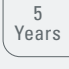
	Made in Germany		Colour rendering index (Ra)		Ambient temperature for use (°C)
	Voltage connection		Light colour in Kelvin Binning according to 3-step MacAdam ellipse colour sorting		Light is dimmable, but does not have an internal dimmer
	Electrical protection class		RGB LED chips (additionally with hybrid lights)		Light has an internal dimmer
	IP protection type		LED service life in operating hours of continu- ous operation		Maintenance-free
	Resistant to flying chips, shock, vibration, oil and coolant		Connection type		ETL listed (UL/CSA), safety test seal
	Beam angle/beam characteristics		Cable length in metres		Warranty in years



© LED2WORK GmbH, 2026 | 3rd revised edition

This brochure has been carefully prepared. Subject to printing errors, mistakes and technical changes.

**Imprint:**

LED2WORK GmbH  
Stuttgarter Strasse 13A  
75179 Pforzheim/Germany  
Tel. +49 7231 44920-00  
info@led2work.com  
www.led2work.com  
shop.led2work.com

Image sources:

stock.adobe.com and

Images on pages 20, 22, 24: Bott GmbH & Co. KG, Bahnstrasse 17, 74405 Gaildorf, Germany

Image on page 18: © WILD Gruppe | WILD GmbH, 9100 Völkemark, Austria, www.wild.at

All other images © LED2WORK GmbH | www.led2work.com | Instagram: @led2work



**Information?**

**Orders?**

**Request a quotation?**

**+49 7231 44920-10**

**sales@led2work.com**

**Or order directly:**

**shop.led2work.com**

**www.led2work.com**

# LED2WORK

INTELLIGENCE IN LIGHT

**LED2WORK GmbH**  
Stuttgarter Str. 13A  
75179 Pforzheim | Germany  
T +49 7231 44920-00  
info@led2work.com

**www.led2work.com**  
**shop.led2work.com**



**Carbon neutral**  
Print product  
ClimatePartner.com/12518-1907-1001

