

# Raccords en laiton accessoires Sprint® Série S2000

Raccordement: BSP (G1/8", G1/4", G3/8", G1/2"),  
BSPT (R1/8", R1/4", R3/8", R1/2")



Les raccords accessoires Sprint® existent en 14 modèles différents. La particularité de cette série est l'intégration de la bague Sprint®, évitant l'utilisation d'un produit d'étanchéité qui engendre une perte de temps au montage. Ce système garantit plusieurs montages et démontages du raccord.

La bague Téflon Sprint® permet une parfaite étanchéité sans aucune préparation du filetage. Ainsi, il n'y a pas de pollution de l'installation par des résidus de liquide ou bande d'étanchéité.

## CARACTERISTIQUES GENERALES

**Raccordement** Gaz conique ISO 7 ( BSPT ) - Gaz cylindrique ISO 228 ( BSP )

**Température** -40 à + 120°C

**Fluide** Air comprimé et autres fluides basse pression

**Matériaux** Laiton nickelé - Bague d'étanchéité PTFE

**Pression** 80 bar

## Raccords accessoires Sprint®

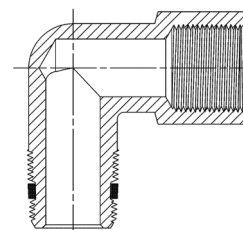

### Raccord Mod. S2500



Mamelon Egal Conique SPRINT®

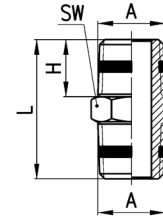

DIMENSIONS					
Mod.	A	H	L	SW	Poids (g)
S2500 1/8	R1/8	7,5	19,5	12	8
S2500 1/4	R1/4	11	27	14	15
S2500 3/8	R3/8	11,5	28	17	21
S2500 1/2	R1/2	14	33,5	22	39

### Raccord Mod. S2530



Conique  
Réduction côté femelle < côté mâle

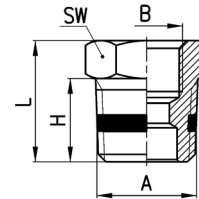

DIMENSIONS						
Mod.	A	B	H	L	SW	Poids (g)
S2530 1/4-1/8	R1/4	G1/8	11	16	14	9
S2530 3/8-1/8	R3/8	G1/8	11,5	16,5	17	16
S2530 1/2-1/8	R1/2	G1/8	14	19,5	22	13
S2530 3/8-1/4	R3/8	G1/4	11,5	16,5	17	33
S2530 1/2-1/4	R1/2	G1/4	14	19,5	22	32
S2530 1/2-3/8	R1/2	G3/8	14	19,5	22	22

### Raccord Mod. S2520



Conique  
Augmentation : côté femelle > côté mâle

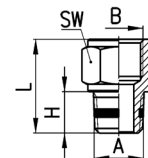

DIMENSIONS						
Mod.	A	B	H	L	SW	Poids (g)
S2520 1/8-1/8	R1/8	G1/8	7,5	17,5	13	11
S2520 1/8-1/4	R1/8	G1/4	7,5	19	17	15
S2520 1/8-3/8	R1/8	G3/8	7,5	20	20	19
S2520 1/4-1/4	R1/4	G1/4	11	22,5	17	17
S2520 1/4-3/8	R1/4	G3/8	11	23,5	20	33
S2520 1/4-1/2	R1/4	G1/2	11	27,5	24	34
S2520 3/8-3/8	R3/8	G3/8	11,5	24	20	36
S2520 3/8-1/2	R3/8	G1/2	11,5	28	24	56
S2520 1/2-1/2	R1/2	G1/2	14	30,5	24	41

### Raccord Mod. S2510



Mamelon Inégal Conique

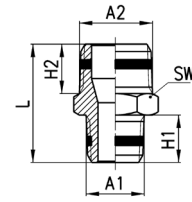

DIMENSIONS							
Mod.	A1	A2	H1	H2	L	SW	Poids ( g )
S2510 1/8-1/4	R1/8	R1/4	7,5	11	23,5	14	14
S2510 1/8-3/8	R1/8	R3/8	7,5	11,5	24	17	22
S2510 1/4-3/8	R1/4	R3/8	11	11,5	27,5	17	19
S2510 1/4-1/2	R1/4	R1/2	11	14	30,5	22	33
S2510 3/8-1/2	R3/8	R1/2	11,5	14	31	22	36

### Raccord Mod. S2541



Adaptateur Egal Mâle/Femelle Orientable Cylindrique

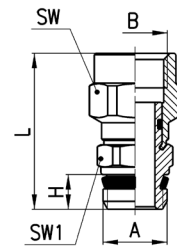

DIMENSIONS							
Mod.	A	B	H	L	SW	SW1	Poids ( g )
S2541 1/8-1/8	G1/8	G1/8	5,5	28	13	14	17
S2541 1/4-1/4	G1/4	G1/4	7	31,5	17	14	26
S2541 3/8-3/8	G3/8	G3/8	8	34	20	19	39

### Raccord Mod. S2010



Coude Mâle Egal Conique

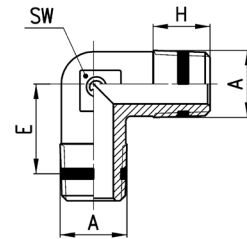

DIMENSIONS					
Mod.	A	E	H	SW	Poids ( g )
S2010 1/8	R1/8	11,5	7,5	9	9
S2010 1/4	R1/4	13,5	11	12	17
S2010 3/8	R3/8	15,5	11,5	14	25
S2010 1/2	R1/2	16	14	16	47

### Raccord Mod. S2020



Coude Mâle/Femelle Egal Conique

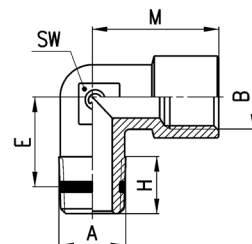

DIMENSIONS							
Mod.	A	B	E	H	M	SW	Poids ( g )
S2020 1/8-1/8	R1/8	G1/8	11,5	8,5	19	11	16
S2020 1/4-1/4	R1/4	G1/4	15	11	23	13	27
S2020 3/8-3/8	R3/8	G3/8	15	11,5	25	15	33
S2020 1/2-1/2	R1/2	G1/2	17,5	14	31,5	20	62

### Raccord Mod. S2050

Té M/M/F Egal Conique

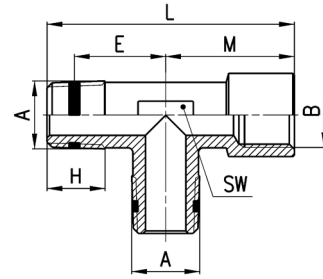

DIMENSIONS								
Mod.	A	B	E	H	L	M	SW	Poids ( g )
S2050 1/8-1/8	R1/8	G1/8	11,5	8,5	37	19	12	14
S2050 1/4-1/4	R1/4	G1/4	15	11	46	23	13	44
S2050 3/8-3/8	R3/8	G3/8	15	11,5	48,5	25	16	59
S2050 1/2-1/2	R1/2	G1/2	17,5	14	60,5	31,5	20	81

### Raccords Mod. S2060

Té Mâle au Centre Egal Conique

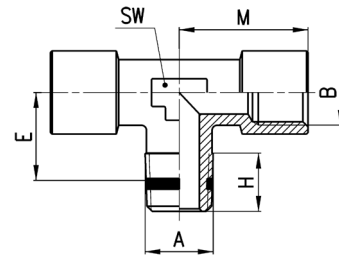

DIMENSIONS								
Mod.	A	B	E	H	M	SW	Poids ( g )	
S2060 1/8-1/8	R1/8	G1/8	11,5	8,5	19	12	31	
S2060 1/4-1/4	R1/4	G1/4	15	11	23	13	38	
S2060 3/8-3/8	R3/8	G3/8	15	11,5	25	16	51	
S2060 1/2-1/2	R1/2	G1/2	17,5	14	31,5	20	88	

### Raccord Mod. S2070

Té M/F/F Egal Conique Sprint®

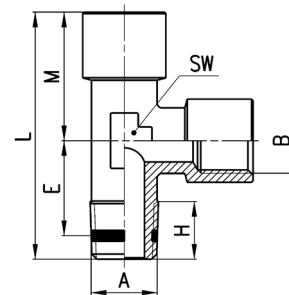

DIMENSIONS								
Mod.	A	B	E	H	L	M	SW	Poids ( g )
S2070 1/8-1/8	R1/8	G1/8	11,5	8,5	37	19	12	30
S2070 1/4-1/4	R1/4	G1/4	15	11	46	23	13	36
S2070 3/8-3/8	R3/8	G3/8	15	11,5	48,5	25	16	51
S2070 1/2-1/2	R1/2	G1/2	17,5	14	60,5	31,5	20	89

**Raccord Mod. S2080**

Té Mâle Egal Conique

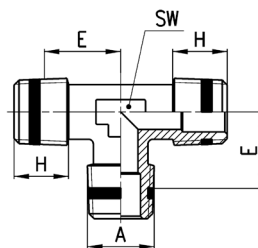

DIMENSIONS					
Mod.	A	E	H	SW	Poids (g)
S2080 1/8	R1/8	11,5	7,5	9	14
S2080 1/4	R1/4	13,5	11	12	31
S2080 3/8	R3/8	15,5	11,5	14	50
S2080 1/2	R1/2	16	14	16	63

**Raccord Mod. S2090**

Té M/F/M Egal Conique

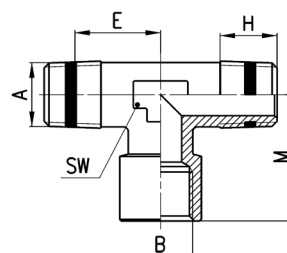

DIMENSIONS							
Mod.	A	B	E	H	M	SW	Poids (g)
S2090 1/8-1/8	R1/8	G1/8	11,5	8,5	19	12	22
S2090 1/4-1/4	R1/4	G1/4	15	11	23	13	16
S2090 3/8-3/8	R3/8	G3/8	15	11,5	25	16	59
S2090 1/2-1/2	R1/2	G1/2	17,5	14	31,5	20	80

**Raccords Mod. 2612**

**Nouveaux modèles**

Bouchon Mâle Cylindrique

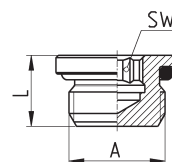

DIMENSIONS				
Mod.	A	L	SW	Poids (g)
2612 M5	M5	5.5	2	1
2612 M7	M7	7	4	2
2612 1/8	G1/8	8.5	4	5
2612 1/4	G1/4	9.5	6	9
2612 3/8	G3/8	10.5	8	17
2612 1/2	G1/2	11.5	12	25

**Raccords Mod. S2610**

Bouchon Mâle Cylindrique Sprint®

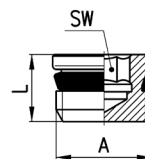

DIMENSIONS				
Mod.	A	L	SW	Poids (g)
S2610 1/8	G1/8	7.5	4	3
S2610 1/4	G1/4	9	6	6
S2610 3/8	G3/8	10	8	12
S2610 1/2	G1/2	11	10	21

**Raccord Mod. S2615**

Bouchon Mâle Conique

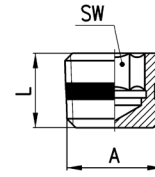

DIMENSIONS				
Mod.	A	L	SW	Poids ( g )
S2615 1/8	R1/8	8	5	2
S2615 1/4	R1/4	10	7	6
S2615 3/8	R3/8	10	8	12

# Raccords en laiton accessoires Séries 2000 et FR2000

Raccordement: métrique (M5),  
BSP (G1/8", G1/4", G3/8", G1/2", G3/4", G1"),  
BSPT (R1/8", R1/4", R3/8", R1/2", R3/4", R1")



Lors d'opération de maintenance ou de réalisation d'une installation, il est souvent difficile de prévoir les raccords nécessaires. C'est pour cette raison que les raccords accessoires assurent un rôle important dans la mise en œuvre d'une installation. La gamme accessoires, constituée de raccords droits, en L, en T, en croix... etc... est disponible en différents modèles allant jusqu'à 1".

## CARACTERISTIQUES GENERALES

<b>Raccordement</b>	Gaz conique ISO 7 ( BSPT ) Gaz cylindrique ISO 228 ( BSP )
<b>Température</b>	-40 à + 120°C
<b>Fluide</b>	Air comprimé et autres fluides basse pression
<b>Matériaux</b>	Laiton nickelé
<b>Pression</b>	80 bar

## Raccords accessoires

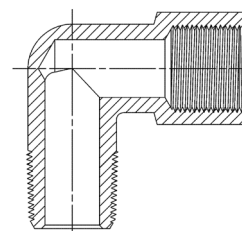

### Raccord Mod. 2500



Mamelon Egal Conique

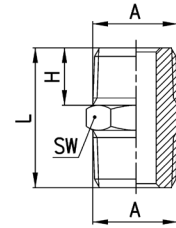

DIMENSIONS					
Mod.	A	H	L	SW	Poids ( g )
2500 1/8	R1/8	7,5	19,5	12	9
2500 1/4	R1/4	11	27	14	16
2500 3/8	R3/8	11,5	28	17	21
2500 1/2	R1/2	14	33,5	22	41
2500 3/4	R3/4	16,5	40	27	80
2500 1	R1	19	45,5	34	125

### Raccord Mod. 2501



Mamelon Egal Métrique-Cylindrique

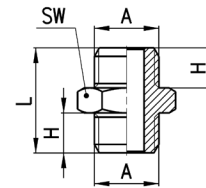

DIMENSIONS					
Mod.	A	H	L	SW	Poids ( g )
2501 M5	M5	4	11,5	8	2
2501 1/8	G1/8	6	16,5	13	9
2501 1/4	G1/4	8	21	17	15
2501 3/8	G3/8	9	23	19	21
2501 1/2	G1/2	10	25,5	24	35

### Raccord Mod. 2510



Mamelon Inégal Conique

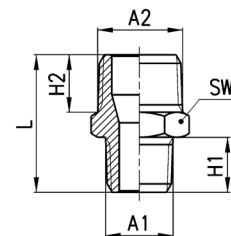

DIMENSIONS							
Mod.	A1	A2	H2	H1	L	SW	Poids ( g )
2510 1/8-1/4	R1/8	R1/4	11	7,5	23,5	14	14
2510 1/8-3/8	R1/8	R3/8	11,5	7,5	24	17	18
2510 1/4-3/8	R1/4	R3/8	11,5	11	27,5	17	20
2510 1/4-1/2	R1/4	R1/2	14	11	30,5	22	34
2510 3/8-1/2	R3/8	R1/2	14	11,5	31	22	34
2510 1/2-3/4	R1/2	R3/4	16,5	14	37,5	27	67



**Raccord Mod. 2520**

Augmentation Conique  
côté femelle > côté mâle

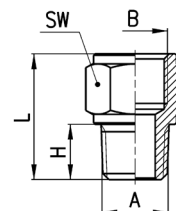

DIMENSIONS						
Mod.	A	B	H	L	SW	Poids ( g )
2520 1/8-1/8	R1/8	G1/8	7,5	17,5	13	9
2520 1/8-1/4	R1/8	G1/4	7,5	19	17	15
2520 1/8-3/8	R1/8	G3/8	7,5	20	20	19
2520 1/4-1/4	R1/4	G1/4	11	22,5	17	17
2520 1/4-3/8	R1/4	G3/8	11	23,5	20	21
2520 1/4-1/2	R1/4	G1/2	11	27,5	24	35
2520 3/8-3/8	R3/8	G3/8	11,5	24	20	23
2520 3/8-1/2	R3/8	G1/2	11,5	28	24	37
2520 1/2-1/2	R1/2	G1/2	14	30,5	24	41

**Raccord Mod. 2521**

Augmentation Cylindrique  
côté femelle > côté mâle

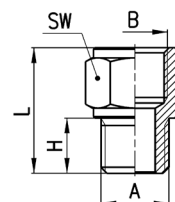

DIMENSIONS						
Mod.	A	B	H	L	SW	Poids ( g )
2521 M5-1/8	M5	G1/8	4	14	13	7
2521 1/8-1/8	G1/8	G1/8	6	16	13	8
2521 1/8-1/4	G1/8	G1/4	6	17,5	17	14
2521 1/8-3/8	G1/8	G3/8	6	18,5	20	30
2521 1/4-1/4	G1/4	G1/4	8	19,5	17	16
2521 1/4-3/8	G1/4	G3/8	8	20,5	20	20
2521 1/4-1/2	G1/4	G1/2	8	24,5	24	33
2521 3/8-3/8	G3/8	G3/8	9	21,5	20	22
2521 3/8-1/2	G3/8	G1/2	9	25,5	24	35
2521 1/2-1/2	G1/2	G1/2	10	26,5	24	36

### Raccord Mod. 2511



Mamelon Inégal Métrique-Cylindrique

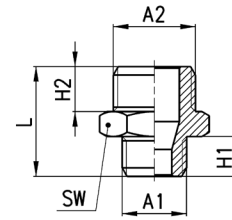

DIMENSIONS							
Mod.	A1	A2	H1	H2	L	SW	Poids ( g )
2511 M5-1/8	M5	G1/8	4	6	14,5	13	8
2511 1/8-1/4	G1/8	G1/4	6	8	19	17	15
2511 1/8-3/8	G1/8	G3/8	6	9	20	19	19
2511 1/4-3/8	G1/4	G3/8	8	9	22	19	20
2511 1/4-1/2	G1/4	G1/2	8	10	23,5	24	32
2511 3/8-1/2	G3/8	G1/2	9	10	24,5	24	34

### Raccord Mod. 2525



Prolongateur Mâle/femelle

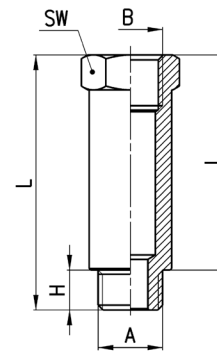

DIMENSIONS							
Mod.	A	B	H	I	L	SW	Poids ( g )
2525 1/8-16	G1/8	G1/8	6	16	22	13	12
2525 1/8-36	G1/8	G1/8	6	36	42	13	24
2525 1/4-27	G1/4	G1/4	8	27	35	17	30
2525 1/4-43	G1/4	G1/4	8	43	51	17	45

### Raccord Mod. 2530



Réduction Conique  
côté femelle < côté mâle

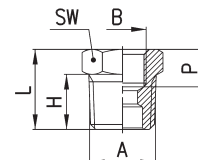

DIMENSIONS							
Mod.	A	B	H	P (min)	L	SW	Poids ( g )
2530 1/4-1/8	R1/4	G1/8	11	6	16	14	9
2530 3/8-1/8	R3/8	G1/8	11,5	8,5	16,5	17	17
2530 1/2-1/8	R1/2	G1/8	14	9,5	19,5	22	12
2530 3/8-1/4	R3/8	G1/4	11,5	7	16,5	17	34
2530 1/2-1/4	R1/2	G1/4	14	9,5	19,5	22	30
2530 1/2-3/8	R1/2	G3/8	14	8	19,5	22	24
2530 3/4-3/8	R3/4	G3/8	16,5	11,5	23	27	67
2530 3/4-1/2	R3/4	G1/2	16,5	9,5	23,5	27	48
2530 1-1/2	R1	G1/2	19	14	27	34	131

### Raccord Mod. 2531

Réduction Cylindrique  
côté femelle < côté mâle

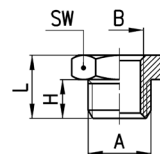

DIMENSIONS							
Mod.	A	B	H	L	SW	Poids ( g )	
2531 1/8-M5	G1/8	M5	6	10,5	13	8	*
2531 1/4-1/8	G1/4	G1/8	8	13	17	11	*
2531 3/8-1/8	G3/8	G1/8	9	14	19	17	
2531 3/8-1/4	G3/8	G1/4	9	14	19	12	*
2531 1/2-1/8	G1/2	G1/8	10	15,5	24	32	
2531 1/2-1/4	G1/2	G1/4	10	15,5	24	29	
2531 1/2-3/8	G1/2	G3/8	10	15,5	24	22	*

\* = Modèle taraudé sur toute sa longueur

### Raccord Mod. 2543

Manchon Egal

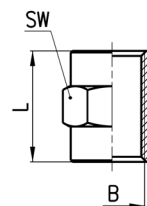

DIMENSIONS				
Mod.	B	L	SW	Poids ( g )
2543 M5	M5	11	8	3
2543 1/8	G1/8	15	13	8
2543 1/4	G1/4	22	17	19
2543 3/8	G3/8	23	20	19
2543 1/2	G1/2	28	24	29

### Raccordi Mod. 2553

Manchon Inégal

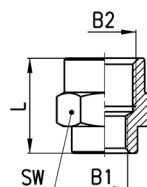

DIMENSIONS					
Mod.	B1	B2	L	SW	Poids ( g )
2553 M5-1/8	M5	G1/8	13.5	13	7
2553 1/8-1/4	G1/8	G1/4	17	17	18
2553 1/8-3/8	G1/8	G3/8	18	20	18
2553 1/8-1/2	G1/8	G1/2	21.5	24	28
2553 1/4-3/8	G1/4	G3/8	21.5	20	21
2553 1/4-1/2	G1/4	G1/2	23	24	32
2553 3/8-1/2	G3/8	G1/2	24	24	31

### Raccord Mod. 2611

Bouchon Mâle Cylindrique

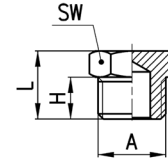

DIMENSIONS					
Mod.	A	H	L	SW	Poids ( g )
2611 M5	M5	4	7,5	8	2
2611 1/8	G1/8	6	10,5	13	7
2611 1/4	G1/4	8	13	17	13
2611 3/8	G3/8	9	14	19	18
2611 1/2	G1/2	10	15,5	24	31
2611 1	G1	13	19	38	76

### Raccord Mod. 2610 3/4

Bouchon Mâle Conique

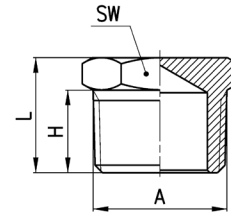

DIMENSIONS					
Mod.	A	H	L	SW	Poids ( g )
2610 3/4	R3/4	16,5	23	27	61

### Raccord Mod. 2613

Bouchon Femelle cylindrique

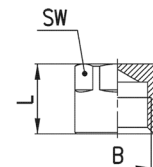

DIMENSIONS				
Mod.	B	L	SW	Poids ( g )
2613 1/8	G1/8	11	12	6
2613 1/4	G1/4	13,5	15	13
2613 3/8	G3/8	15,5	18	19
2613 1/2	G1/2	22,5	19	33

**Raccord Mod. 2601**

Embout Cannelé Mâle  
Métrique-Cylindrique

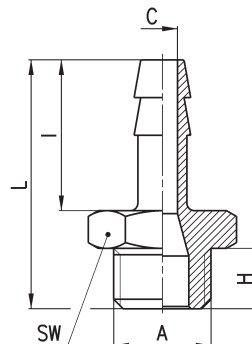

DIMENSIONS								
Mod.	N	A	C	H	I	L	SW	Poids ( g )
2601 2-M5	2	M5	1,2	4	8	16	8	2
2601 4,5-M5	4	M5	2,5	4	15	23	8	3
2601 7-1/8	7	G1/8	4	6	20	30	12	9
2601 7-1/4	7	G1/4	4	8	20	33	17	16
2601 8-1/8	8	G1/8	5	6	20	30	12	10
2601 9-1/8	9	G1/8	5,5	6	20	30	12	11
2601 9-1/4	9	G1/4	6	8	20	33	17	17
2601 9-3/8	9	G3/8	6	9	20	34	19	21
2601 12-1/4	12	G1/4	8,5	8	20	33	17	20
2601 12-3/8	12	G3/8	9	9	20	34	19	23
2601 12-1/2	12	G1/2	9	10	20	35,5	24	34
2601 17-3/8	17	G3/8	12	9	24	38	19	31
2601 17-1/2	17	G1/2	13	10	24	39,5	24	41

**Raccord Mod. 2013**

Coude Femelle Egal

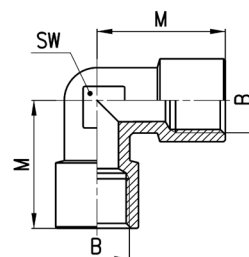

DIMENSIONS				
Mod.	B	M	SW	Poids ( g )
2013 1/8	G1/8	19	11	16
2013 1/4	G1/4	23	14	28
2013 3/8	G3/8	25	16	39
2013 1/2	G1/2	31,5	20	69

### Raccord Mod. 2010

Coude Mâle Egal Conique

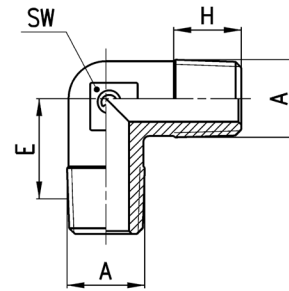

DIMENSIONS					
Mod.	A	E	H	SW	Poids (g)
2010 1/8	R1/8	11,5	7,5	9	10
2010 1/4	R1/4	13,5	11	12	18
2010 3/8	R3/8	15,5	11,5	14	28
2010 1/2	R1/2	16	14	16	47
2010 3/4	R3/4	19	16	25	103
2010 1	R1	23	17	30	183

### Raccord Mod. 2021 et 2020

Mod. 2021: Coude Mâle/Femelle Egal Métrique  
Mod. 2020: Coude Mâle/Femelle Egal Conique

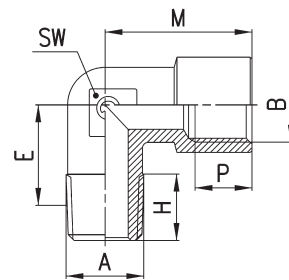

DIMENSIONS								
Mod.	A	B	E	H	M	P (min)	SW	Poids (g)
2021 M5-M5	M5	M5	9	4	10,5	4,5	9	7
2020 1/8-1/8	R1/8	G1/8	11,5	8,5	19	6	11	17
2020 1/4-1/4	R1/4	G1/4	15	11	23	7	13	27
2020 3/8-3/8	R3/8	G3/8	15	11,5	25	8	15	33
2020 1/2-1/2	R1/2	G1/2	17,5	14	31,5	9,5	20	63
2020 3/4-3/4	R3/4	G3/4	19	16	36,5	16,5	25	126
2020 1-1	R1	G1	23	17	45	19	30	209

### Raccord Mod. 2050

Té M/M/F Egal Conique

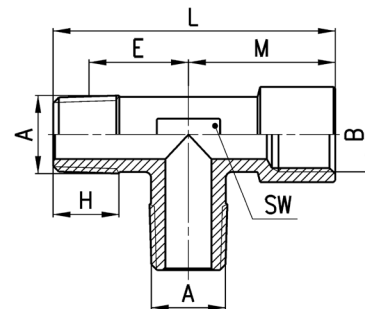

DIMENSIONS								
Mod.	A	B	E	H	L	M	SW	Poids (g)
2050 1/8-1/8	R1/8	G1/8	11,5	8,5	37	19	12	27
2050 1/4-1/4	R1/4	G1/4	15	11	46	23	13	35
2050 3/8-3/8	R3/8	G3/8	15	11,5	48,5	25	16	44
2050 1/2-1/2	R1/2	G1/2	17,5	14	60,5	31,5	20	83

### Raccord Mod. 2060

Té Mâle au Centre Egal Conique

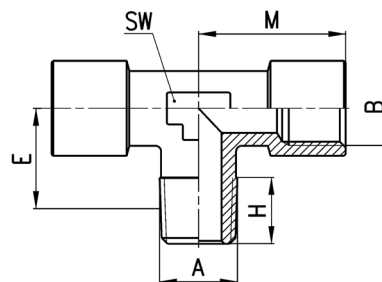

DIMENSIONS							
Mod.	A	B	E	H	M	SW	Poids ( g )
2060 1/8-1/8	R1/8	G1/8	11,5	8,5	19	12	22
2060 1/4-1/4	R1/4	G1/4	15	11	23	13	38
2060 3/8-3/8	R3/8	G3/8	15	11,5	25	16	49
2060 1/2-1/2	R1/2	G1/2	17,5	14	31,5	20	89

### Raccord Mod. 2080

Té Mâle Egal Conique

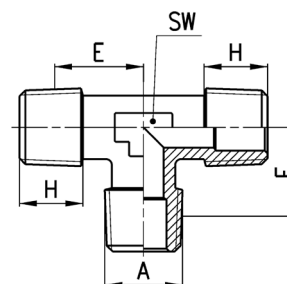

DIMENSIONS					
Mod.	A	E	H	SW	Poids ( g )
2080 1/8	R1/8	11,5	7,5	9	14
2080 1/4	R1/4	13,5	11	12	25
2080 3/8	R3/8	15,5	11,5	14	39
2080 1/2	R1/2	16	14	16	82
2080 3/4	R3/4	19	16,2	25	135
2080 1	R1	23	17,5	30	239

### Raccord Mod. 2070

Té M/F/F Egal Conique

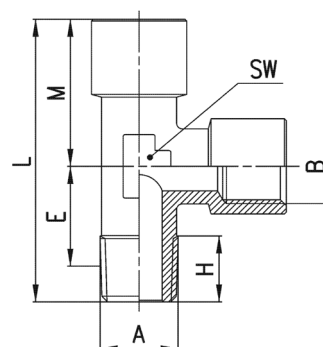

DIMENSIONS								
Mod.	A	B	E	H	L	M	SW	Poids ( g )
2070 1/8-1/8	R1/8	G1/8	11,5	8,5	37	19	12	22
2070 1/4-1/4	R1/4	G1/4	15	11	46	23	13	37
2070 3/8-3/8	R3/8	G3/8	15	11,5	48,5	25	16	49
2070 1/2-1/2	R1/2	G1/2	17,5	14	60,5	31,5	20	89

### Raccord Mod. 2090

Té M/F/M Egal Conique

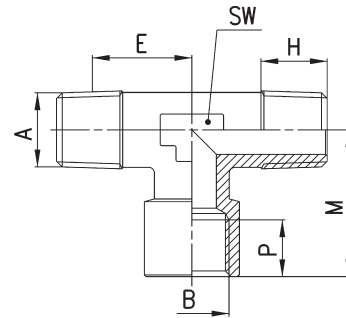

DIMENSIONS								
Mod.	A	B	E	H	M	P	SW	Poids ( g )
2090 1/8-1/8	R1/8	G1/8	11,5	8,5	19	6	12	22
2090 1/4-1/4	R1/4	G1/4	15	11	23	7	13	37
2090 3/8-3/8	R3/8	G3/8	15	11,5	25	8	16	44
2090 1/2-1/2	R1/2	G1/2	17,5	14	31,5	9,5	20	83
2090 3/4-3/4	R3/4	G3/4	19	16	36,5	16,5	25	156
2090 1-1	R1	G1	23	17,5	45	19	30	262

### Raccord Mod. 2003

Té Femelle Egal cylindrique

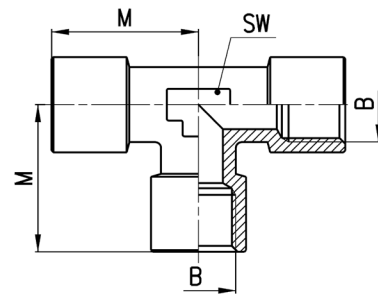

DIMENSIONS				
Mod.	B	M	SW	Poids ( g )
2003 1/8	G1/8	19	12	23
2003 1/4	G1/4	23	13	39
2003 3/8	G3/8	25	16	54
2003 1/2	G1/2	31,5	20	97

### Raccord Mod. 2040

Y Mâle au Centre Egal Conique

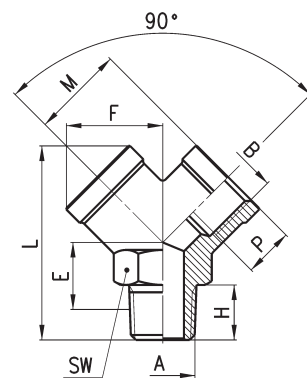

DIMENSIONS										
Mod.	A	B	E	F	H	L	M	P	SW	Poids ( g )
2040 1/8-1/8	R1/8	G1/8	9,5	14,5	8	32	14	8	13	22
2040 1/4-1/4	R1/4	G1/4	12	18	11	38	17,5	11	17	38
2040 3/8-3/8	R3/8	G3/8	13,5	20,5	11,5	42,5	19	11,5	20	52
2040 1/2-1/2	R1/2	G1/2	15,5	26,5	14	53	24,5	14	25	110



### Raccord Mod. 2043

Y Femelle Egal Conique

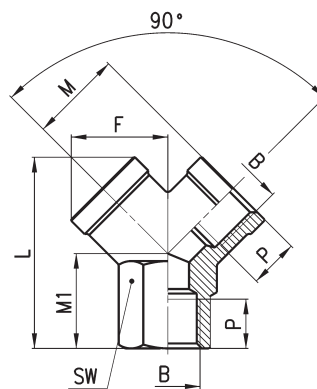

DIMENSIONS									
Mod.	B	F	L	M	M1	P	SW	Poids (g)	
2043 1/8	G1/8	14,5	26,5	14	12	8	13	18	
2043 1/4	G1/4	18	32	17,5	14	11	17	32	
2043 3/8	G3/8	20,5	37	19	16	11,5	20	44	
2043 1/2	G1/2	26,5	45	24,5	19	14	25	84	

### Raccord Mod. 2033

Croix Femelle

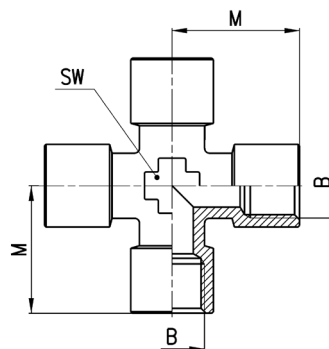

DIMENSIONS				
Mod.	B	M	SW	Poids (g)
2033 1/8	G1/8	19	12	27
2033 1/4	G1/4	23	14	51
2033 3/8	G3/8	25	16	70

### Raccord Mod. 2023

Banjo Simple Femelle cylindrique

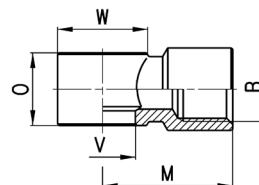

DIMENSIONS							
Mod.	B	M	O	V	W	Poids (g)	assemblage avec Mod.
2023 M5-M5	M5	10.5	9	5.1	9	6	1631
2023 M5-M6	M5	10.5	9	5.1	9	6	SCU, SVU, SCO...
2023 1/8-1/8	G1/8	20	14.5	9.8	∅ 14	14	1631, 1635, SCU, SVU, SCO...
2023 1/4-1/4	G1/4	23.5	14.5	13.2	∅ 18	21	1635, SCU, SVU, SCO...
2023 3/8-3/8	G3/8	26.5	14.5	16.7	∅ 21	27	1635, SCU, SVU, SCO...