

Deublin Rotary Unions – In-the-Shaft Mounted

To meet the specifications of engineering designs requiring minimum overhang, Deublin can provide unions which can be mounted in the shaft. With these models the only extensions beyond the end of the shaft are the supply line connections. Detailed drawings suggesting the application of these Deublin Rotary Unions to your installation will be submitted on request and without obligation.

Model 1005-000-001, DN 6

Operating Data

Maximum Air Pressure	150 PSI	10 bar
Maximum Hydraulic Pressure	1,000 PSI	70 bar
Maximum Speed	3,500 RPM	3,500 min ⁻¹
Maximum Temperature	250 °F	121 °C

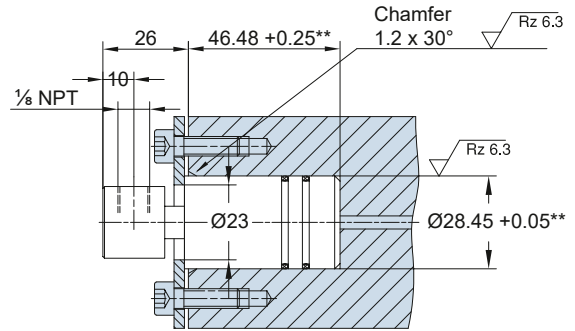

** Dimensions of Shaft Bore

Model 1005-000-038, DN 6

Operating Data

Maximum Air Pressure	150 PSI	10 bar
Maximum Hydraulic Pressure*	1,000 PSI	70 bar
Maximum Speed*	3,500 RPM	3,500 min ⁻¹
Maximum Temperature	250 °F	121 °C

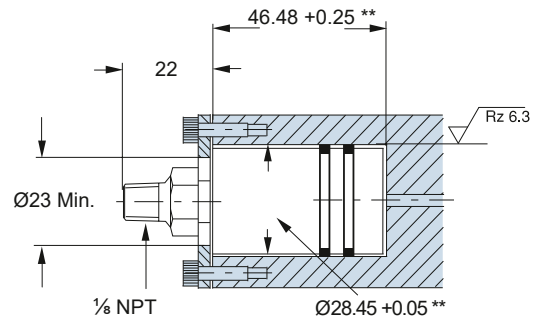

** Dimensions of Shaft Bore

Model 1005-000-049, DN 6

Operating Data

Maximum Air Pressure	150 PSI	10 bar
Maximum Hydraulic Pressure	1,000 PSI	70 bar
Maximum Speed	3,500 RPM	3,500 min ⁻¹
Maximum Temperature	250 °F	121 °C

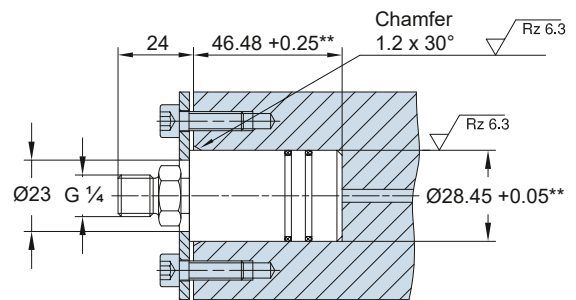

** Dimensions of Shaft Bore

Model 1102-025-081, DN 8

Operating Data

Maximum Air Pressure	150 PSI	10 bar
Maximum Hydraulic Pressure*	1,000 PSI	70 bar
Maximum Speed*	3,500 RPM	3,500 min ⁻¹
Maximum Temperature	250 °F	121 °C

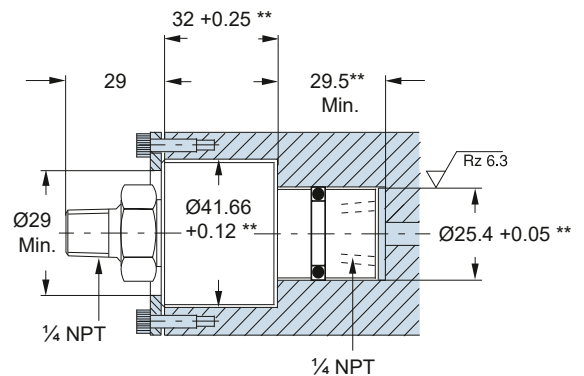

** Dimensions of Shaft Bore

Deublin Rotary Unions – In-the-Shaft Mounted

To meet the specifications of engineering designs requiring minimum overhang, Deublin can provide unions which can be mounted in the shaft. With these models the only extensions beyond the end of the shaft are the supply line connections. Detailed drawings suggesting the application of these Deublin Rotary Unions to your installation will be submitted on request and without obligation.

Model 1102-025-103, DN 8

Operating Data		
Maximum Air Pressure	150 PSI	10 bar
Maximum Hydraulic Pressure	1,000 PSI	70 bar
Maximum Speed	3,500 RPM	3.500 min ⁻¹
Maximum Temperature	250 °F	121 °C

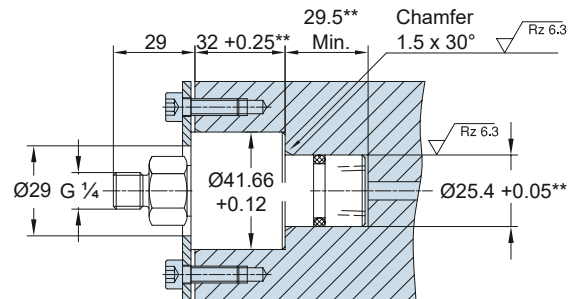

** Dimensions of Shaft Bore

Model 1115-130-002, DN 10

Operating Data		
Maximum Air Pressure	150 PSI	10 bar
Maximum Hydraulic Pressure*	500 PSI	34 bar
Maximum Speed*	3,500 RPM	3.500 min ⁻¹
Maximum Temperature	250 °F	121 °C

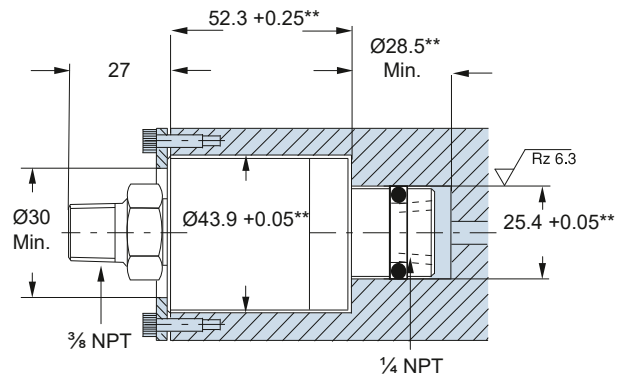

** Dimensions of Shaft Bore

Model 1115-130-205, DN 10

Operating Data		
Maximum Air Pressure	150 PSI	10 bar
Maximum Hydraulic Pressure	500 PSI	34 bar
Maximum Speed	3,500 RPM	3.500 min ⁻¹
Maximum Temperature	250 °F	121 °C

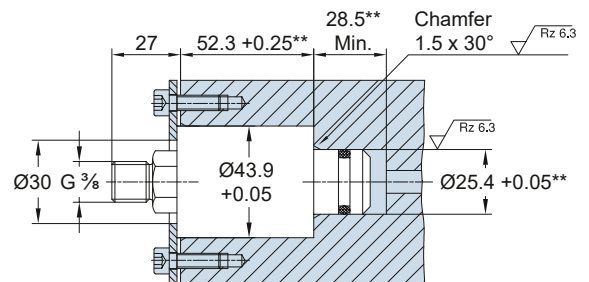

** Dimensions of Shaft Bore

Model 1116-319-248, DN 10

Operating Data		
Maximum Hydraulic Pressure*	1,000 PSI	70 bar
Maximum Speed*	3,500 RPM	3.500 min ⁻¹
Maximum Temperature	250 °F	121 °C



DO NOT RUN DRY

This model contains E.L.S. seals of silicon carbide to silicon carbide for long life on abrasive applications.

** Dimensions of Shaft Bore

