

MOLD COUPLER

Application

- Used for piping of supplying cooling water on moulds.

Feature

- Quick assembly by one touch system.
- Uni-directional shut-off coupler with an automatic shut-off valve built in the socket.
- Useful in narrow space with O.D.(18.5mm).
- Easy to connect or disconnect between cork and hole with long sleeve construction.

Specification

Fluid	Water, Oil
Material	Brass
Working Pressure Range	10kgf/cm ² (1000kPa)
Maximum Pressure	15kgf/cm ² (1500kPa)



Product Code System

KC H 22

① ② ③

① Model

KC	Plug
KH	Socket

② Type

H	Hose Stem
M	Male Thread
F	Female Thread

③ Thread Size(T)

Size	21	22	23
H	1/8"	1/4"	3/8"
M	R1/8	R 1/4	R3/8
F	Rc1/8	Rc 1/4	Rc3/8

Structural Diagram

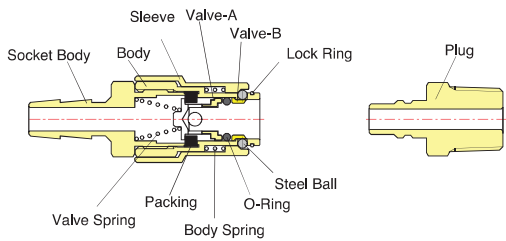

Mold Coupler

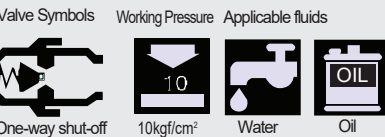

Gland Dimensions for Embedding

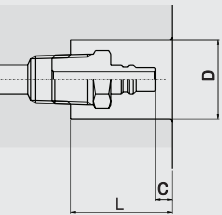

Model	D	C	L
KCM21	20~	0~3	28
KCM22	20~	0~3	29
KCM23	20~	0~3	30

- The size exceeding 3mm causes interference with socket, making connection and disconnection impossible.
- The size "D" is the smallest recommended diameter. Therefore, process the hole in optimal size.

Common Using Precautions of Coupler Series

Never fail to check the following

⚠ WARNING

1. Avoid applying or removing when pressure is on. It causes the danger of jumping of plug body.
2. Never touch the equipment under pressure in the state of putting plug and socket on the body. It causes "opening" by touch.
3. Never use coupler in place of rotary joint or other revolving joint.
4. Secure to flow the fluid from socket to plug.
5. Avoid the instrument or machine giving strong bending weight, excessive vibration or shock.
6. To use the coupler on a vibration tool such as jet chisel, be sure to connect with 30_{cm} rubber tube between tool and coupler.

⚠ CAUTION

1. When putting plug into socket, secure to push it until it stops. Otherwise it may cause leakage. In addition, be sure to check whether it will come out or not by pulling it out.
2. Be careful of plug body jumping by compressed air discharging when disconnecting.
3. Be sure not only to have dust or contamination with intended fluid but also to have flaws on body. It may cause leakage.
4. When pushing tube into the socket body, fix it with hose-band after wearing silicon.
5. Never fasten the thread over maximum limit of torque. It may cause breakage.

KCH

Plug Nipple



MODEL[ØD-T]

Tube (Metric) - Thread(R)		
MODEL	C	ØT
KCH21 BRASS	15	8
KCH22 BRASS	15	10
KCH23 BRASS	15	12

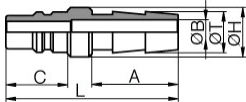

KCM

Plug Male



MODEL[ØD-T]

Tube (Metric) - Thread(R)		
MODEL	C	R
KCM21 BRASS	15	R1/8
KCM22 BRASS	15	R1/4
KCM23 BRASS	15	R3/8

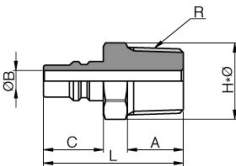

KCF

Plug Female



MODEL[ØD-T]

Tube (Metric) - Thread(R)		
MODEL	C	Rc
KCF21 BRASS	15	Rc1/8
KCF22 BRASS	15	Rc1/4
KCF23 BRASS	15	Rc3/8

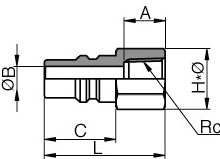

KHH

Socket Nipple



MODEL[ØD-T]

Tube (Metric) - Thread(R)		
MODEL	ØD	ØT
KHH21 BRASS	22	6.5
KHH22 BRASS	22	10
KHH23 BRASS	22	12
KHH24 BRASS	22	16

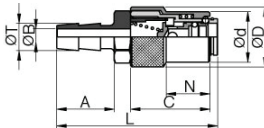

KHM

Socket Male

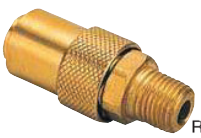

MODEL[ØD-T]

Tube (Metric) - Thread(R)		
MODEL	ØD	R
KHM21 BRASS	22	R1/8
KHM22 BRASS	22	R1/4
KHM23 BRASS	22	R3/8

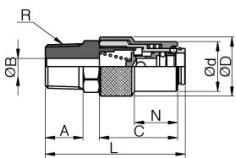

KHF

Socket Female



MODEL[ØD-T]

Tube (Metric) - Thread(R)		
MODEL	ØD	Rc
KHF21 BRASS	22	Rc1/8
KHF22 BRASS	22	Rc1/4

