

F.R.L.  
 F.R.  
 F (Filtr)  
 R (Reg)  
 L (Lub)  
 Drain Separ  
 Mech Press SW  
 Res press exh valve  
 SlowStart  
 Anti-bac/Bac-remove Filtr  
 Film Resist FR  
 Oil-Prohr  
 Med Press FR  
 No Cu/ PTFE FRL  
 Outdrs FRL  
 Adapter Joiner  
 Press Gauge  
 CompFRL  
 LgFRL  
 PrecsR  
 VacF/R  
 Clean FR  
 ElecPneR  
 AirBoost  
 Speed Ctrl  
 Silncr  
 CheckV/ other  
 Fit/Tube  
 Nozzle  
 Air Unit  
 PrecsCompn  
 Electro Press SW  
 ContactSW  
 AirSens  
 PresSW Cool  
 Air Flo Sens/Ctrl  
 WaterRiSens  
 TotAirSys (Total Air)  
 TotAirSys (Gamma)  
 Gas generator  
 RefrDry  
 DesicDry  
 HiPolymDry  
 MainFiltr  
 Dischrg etc  
 Ending



Compact check valve with push-in fitting

# CHL Series

Compact/space saving inline. Vacuum retention and low pressure use are possible.

JIS symbol



## Specifications

Item	CHL-M54	CHL-H44	CHL-H66
Working fluid	Compressed air		
Max. working pressure MPa	1.0 (≈150 psi, 10 bar)		
Min. working pressure MPa	0.03 (≈4.4 psi, 0.3 bar)		
Cracking pressure MPa	0.03 (≈4.4 psi, 0.3 bar)		
Negative pressure range kPa	-30 (≈-4.3 psi, -0.3 bar) to -100 (≈-15 psi, -1 bar)		
Proof pressure MPa	1.5 (≈220 psi, 15 bar)		
Fluid temperature °C	0 (32°F) to 60 (140°F) (no freezing)		
Ambient temperature °C	0 (32°F) to 60 (140°F) (no freezing)		
Port size	M5	ø4	ø6
Weight g	8.9	10.8	16.6
Compatible tube O.D.	ø4	ø4	ø6
Flow rate ℓ/min(ANR)	170	180	440
Effective cross-sectional area mm <sup>2</sup>	2.6	2.8	6.8

Note: Flow rate is the atmospheric pressure conversion value at pressure 0.5 MPa.

## How to order

Model No. **CHL** - **M5** **4** - **A**

A B C M54 type only

A Port size		B Tube O.D.		C Free flow	
M5	M5	4	ø4	A	M5 screw side input
H4	ø4	4	ø4	B	M5 screw side output
H6	ø6	6	ø6		

Note: Combinations other than those listed above are not possible.

Illustration of **C** free flow (M54 type only)

Free flow A (M5 screw side input)

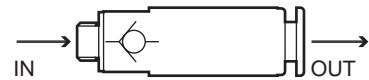

Free flow B (M5 screw side output)

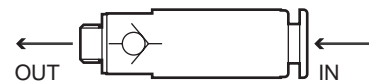

## Clean-room specifications (Catalog No. CB-033SA)

- Anti-dust generation structure for use in cleanrooms

**CHL-.....- P7\***

### Internal structure and parts list

● CHL-M54

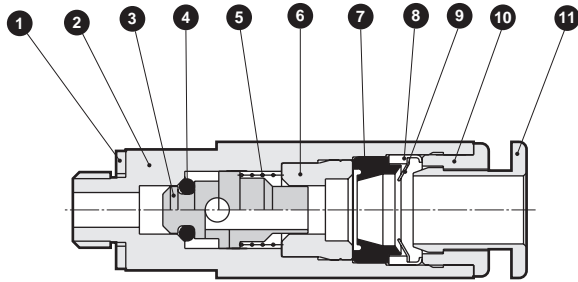

● CHL-H44,H66

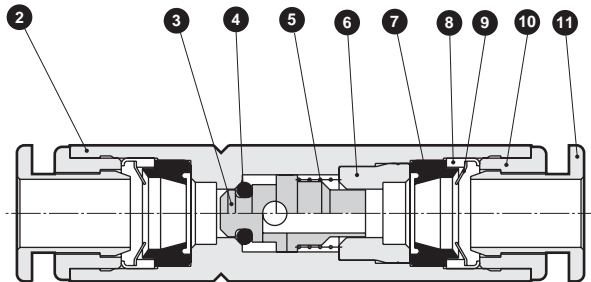

No.	Part name	Material
1	Gasket	Nitrile rubber/steel
2	Body	Copper alloy (electroless nickeling)
3	Valving element	Aluminum
4	O-ring	Nitrile rubber
5	Spring	Stainless steel

No.	Part name	Material
6	Valve seat	Aluminum
7	Packing	Nitrile rubber
8	Chuck holder	Copper alloy (electroless nickeling)
9	Chuck	Stainless steel
10	Outer ring	Copper alloy (electroless nickeling)
11	Push ring	Polybutylene terephthalate

### Dimensions



● CHL-M54-\*

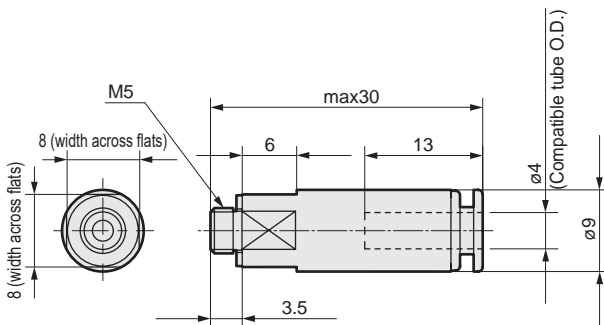

● CHL-H44

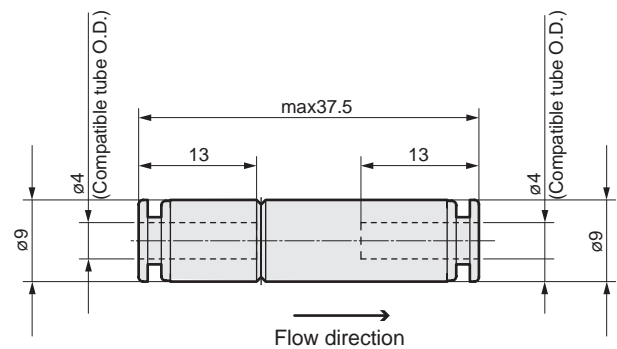

● CHL-H66

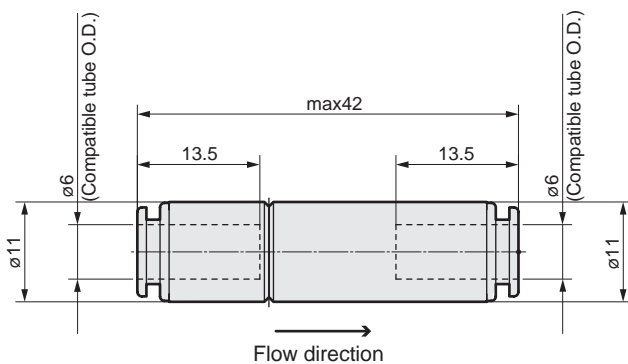

- F.R.L.
- F.R.
- F (Filtr)
- R (Reg)
- L (Lub)
- Drain Separ
- Mech Press SW
- Res press exh valve
- SlowStart
- Anti-bac/Bac-remove Filtr
- Film Resist FR
- Oil-ProhR
- Med Press FR
- No Cu/ PTFE FRL
- Outdr FRL
- Adapter Joiner Press Gauge
- CompFRL
- LgFRL
- PrecsR
- VacF/R
- Clean FR
- ElecPneuR
- AirBoost
- Speed Ctrl
- Silncr
- CheckV/ other
- Fit/Tube
- Nozzle
- Air Unit
- PressCompn
- Electro Press SW
- ContactSW
- AirSens
- PresSW Cool
- Air Flo Sens/Ctrl
- WaterRISens
- TotAirSys (Total Air)
- TotAirSys (Gamma)
- Gas generator
- RefrDry
- DesicDry
- HiPolymDry
- MainFiltr Dischrg etc
- Ending